



1/1 Alan Watt Crescent Casey, ACT 3 2 2

Elevated Townhouse with Panoramic Views and Sophisticated Design

Price: SOLD - \$775,000

- Features Overview:
- North facing
 - Double level floorplan
 - NBN connected with FTTP
 - Age: 10 years (built in 2014)
 - Units plan number: 4045
 - EER (Energy Efficiency Rating): 6.0 Stars

- Development Information:
- Name of development: The Bank
 - Number of buildings in development: 5



Jess Smith
0410 125 475



Shaye Davies
0459 140 665



Ground Level



Upper Level

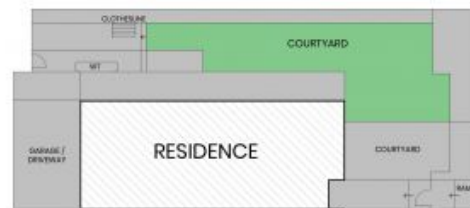

Site Plan



The site plan and floor plan are not to scale; measurements are indicative and in metres. Bushes and trees are placed for illustration purposes. Plans should not be relied on. Interested parties should make and rely on their own enquiries. All other information provided has been collected from reliable sources but cannot be guaranteed for accuracy.

1/1 Alan Watt Crescent
Casey



Upper Level



Ground Level



The floor plan is not to scale; measurements are indicative and in metres. All features included in this 3D plan are for inspiration purposes only. This is not an exact replica of the property or the position of exterior elements. Plans should not be relied on. Interested parties should make and rely on their own enquiries.