



9 Nathan Place Engadine, NSW

3 

2 

2 

Elevated position and character charm

Nestled in a peaceful cul-de-sac this three bedroom family home boasts character-filled charm with its cathedral ceilings, exposed brick and timber beams. Split over multiple levels with the bedrooms in one zone and the living in another, you'll love the serenity of the private bush surroundings. Move-in ready with possibilities to update, it's easily accessible to local shops, schools and transport.

- Large lounge with balcony, cathedral ceilings, exposed brick and timber beams
- Three bedrooms all with built-in robes and ceiling fans, main with ensuite
- Separate dining room, eat-in open kitchen with ample storage and potential
- Good size main bathroom with bathtub, large laundry with storage and toilet
- Elevated fully-fenced level grassed yard with garden shed and bush surrounds
- Double car garage with internal access and extra parking space in the driveway
- Quiet cul-de-sac, easily accessible to shops, schools, transport and facilities
- Move-in ready with potential to update should you desire, ideal family home

Price: Contact Agent

Council Rates: \$299.90 p/q

Water Rates: \$171.41 p/q



Rhys Christofa

0415 684 877



Brayden Watson

0415 122 733



Lower Level



Site Plan



Upper Level



The site plan and floor plan are not to scale; measurements are indicative and in metres. Bushes and trees are placed for illustration purposes. Plans should not be relied on. Interested parties should make and rely on their own enquiries. All other information provided has been collected from reliable sources but cannot be guaranteed for accuracy.

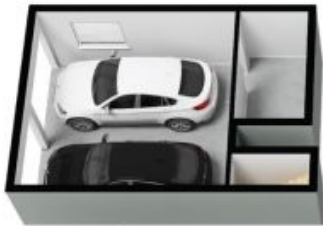

Lower Level



Upper Level



The floor plan is not to scale; measurements are indicative and in metres. All features included in this 3D plan are for inspiration purposes only. This is not an exact replica of the property or the position of exterior elements. Plans should not be relied on. Interested parties should make and rely on their own enquiries.