

15 Homelands Avenue Carlingford, NSW 5 2 2

Perfect Family Home Sitting On Corner Block

This well-maintained home presents an exciting opportunity for both family living and potential duplex development (STCA). Situated on a corner block with 689SQM of land, this property offers versatility and endless possibilities for its new owners. Its convenient location provides easy access to schools, shops, and transport.

Key Features:

- Five generously sized bedrooms, including a master bedroom with ensuite
- Practical kitchen equipped with stainless steel appliances
- Expansive separated formal lounge and dining area, perfect for hosting gatherings
- Double lock-up garage with additional parking on the driveway
- North-facing backyard ensuring sunlight throughout the day
- Zoned for Carlingford West Public School and Cumberland High School, ensuring top-notch education for your children
- Short drive to James Ruse Agriculture High School, the King's School, and Tara Anglican School for Girls

Location:
220m to Calangara Park

Price: Contact Agent
Council Rates: \$542.00 p/q
Water Rates: \$251.00 p/q



Juliet (Jiangmin) Chen
0408 997 997



Jessy Tian
0430 232 699

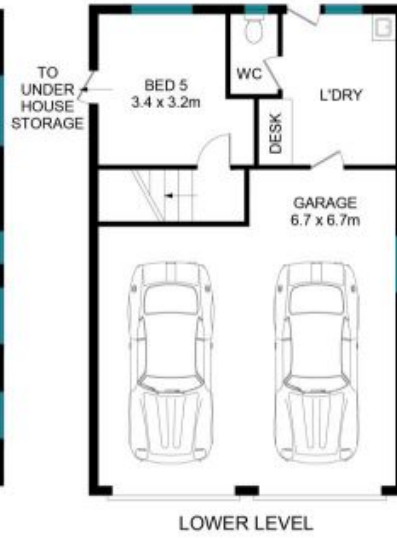

The floor plan is not to scale; measurements are indicative and in metres. Exterior elements are not in position. Plans should not be relied on. Interested parties should make and rely on their own enquiries.

15 Homelands Avenue, Carlingford

