



96 Sladden Road Yarrawarrah, NSW



Serene family living and breathtaking bush outlook

This beautiful family home offers the convenience of four large bedrooms and a home office. Private and peaceful, the undercover porch is the perfect entertaining area with its stunning bush outlook, relaxing lounge and dining. Boasting lots of natural light throughout, it's made for families with a generous living room at the front and an open plan kitchen, dining and lounge at the rear.

Price: \$1,510,000

Water Rates: \$171.41 p/q



Rhys Christofa

0415 684 877



Ezra Malolo

0401 490 024



Site Plan



Upper Ground Floor

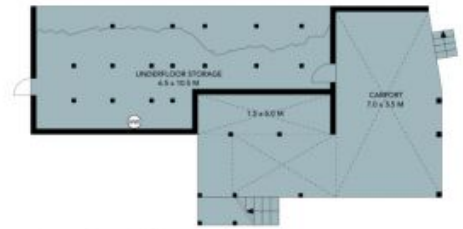

Lower Ground Floor



The site plan and floor plan are not to scale; measurements are indicative and in metres. Bushes and trees are placed for illustration purposes. Plans should not be relied on. Interested parties should make and rely on their own enquiries. All other information provided has been collected from reliable sources but cannot be guaranteed for accuracy.

96 Sladden Road
Yarrowarra



Upper Ground Floor

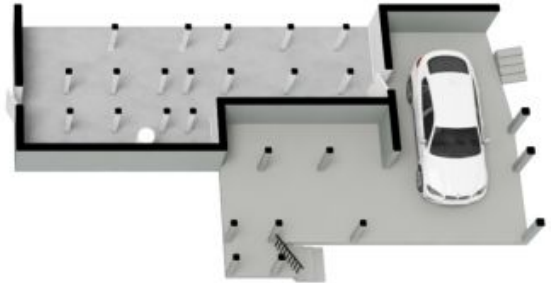

Lower Ground Floor



The floor plan is not to scale; measurements are indicative and in metres. All features included in this 3D plan are for inspiration purposes only. This is not an exact replica of the property or the position of exterior elements. Plans should not be relied on. Interested parties should make and rely on their own enquiries.