

STONE



24 Hope Street Seaforth, NSW

3 

2 

2 

Brand New Townhome Offering Village Lifestyle

Positioned for relaxed living and unparalleled convenience, this brand new luxury townhome is one of just two and exudes a casual elegance with an easy indoor/outdoor flow perfect for the alfresco living and entertaining Australians love. Well-appointed and immaculately-finished, this dual level sanctuary is nestled in a tree-lined street within a short walk of Seaforth village with cafes and restaurants, shopping and express city buses.

- Covered travertine-paved porch to spacious entry foyer/mud-room with custom built-in joinery offering ease and convenience; separate guest powder room
- Open concept living with seamless flow to tiled alfresco area with built-in bbq and benchtop extending out to a private, sunny backyard with level lawn and fire pit area
- Deluxe Caesarstone kitchen with breakfast bar, 900mm freestanding gas/electric cooker with ducted rangehood and generous walk-in pantry
- Luxe parents' retreat with private balcony, walk-in robes, sitting area plus built-in desk and shelving; shower ensuite with Caesarstone vanity

Price:

Price Guide \$2,350,000



Maria Cassarino

0411 818 093



Lauren Sudol

0438 138 675

24 Hope St
Seaforth

STONE



1ST LEVEL



GROUND LEVEL

The floor plan is not to scale; measurements are indicative and in metres. All features included in this 3D plan are for inspiration purposes only. This is not an exact replica of the property or the position of exterior elements. Plans should not be relied on. Interested parties should make and rely on their own enquiries.



SITE PLAN



1ST LEVEL

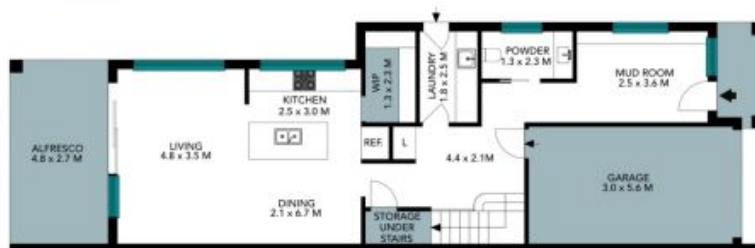

GROUND LEVEL

The site plan and floor plan are not to scale; measurements are indicative and in metres. Bushes and trees are placed for illustration purposes. Plans should not be relied on. Interested parties should make and rely on their own enquiries. All other information provided has been collected from reliable sources but cannot be guaranteed for accuracy.