

1645 Pittwater Road Mona Vale, NSW

5

2

2

### Family comfort in prime Northern Beaches location

This spacious home offers a versatile open-plan layout with five generous bedrooms, including a light-filled living area and gourmet granite kitchen. Step out onto the timber deck overlooking the private garden.

Conveniently located just a short stroll from the beach, shops, cafes, and express city transport, this property embodies the coveted Northern Beaches lifestyle. Close to excellent schools and Mona Vale village amenities, with easy access to recreational facilities. Plus, enjoy a quick CBD commute via Mona Vale Road A3 or the B-line bus services.

Features include:

- Versatile open-plan layout with formal and casual living options
- Light & bright lounge room including fireplace and gas bayonets, with large North-East facing windows showcasing a leafy aspect
- Gourmet granite kitchen with gas cooking, large breakfast bar & ample cupboard space

**Price:** \$1275 per week

**Bond:** \$5,100

**Available Date:** 10/04/2024



**Clare Nasio**

0414 835 724



Upper Level



Lower Level

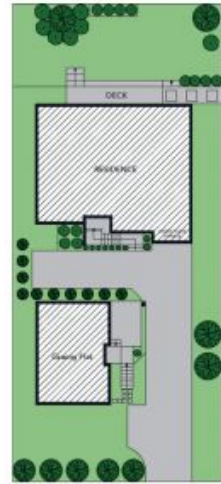

Site Plan



The site plan and floor plan are not to scale; measurements are indicative and in metres. Bushes and trees are placed for illustration purposes. Plans should not be relied on. Interested parties should make and rely on their own enquiries. All other information provided has been collected from reliable sources but cannot be guaranteed for accuracy.

1645 Pittwater Road  
Mona Vale



Upper Level



The floor plan is not to scale, measurements are indicative and in metres. All features included in this 3D plan are for inspiration purposes only. This is not an exact replica of the property or the position of exterior elements. Plans should not be relied on. Interested parties should make and rely on their own enquiries.