

8/19-21 Pacific Highway Roseville, NSW



### House-like rear apartment: two large terraces and stroll to rail

Enjoy an indoor-outdoor lifestyle with the luxury of space in an ultra-convenient location just a 300m level stroll to rail and village. Set to the rear, this oversized full brick apartment with 202sqm approx. on title has it all. Two large garden terraces amplify the single level layout delivering house-like ambience. Stunning renovations in 2021 showcase in the family-size kitchen, sumptuous full bathroom, and modern laundry with powder room. Perfect for couples and families stepping up the property ladder and easy care for downsizers wanting to stay in the area. Come and see for yourself.

- Two spectacular garden terraces create natural flow and easy entertaining
- Full brick construction with new floorboards over slab, lovely high ceilings
- Open living and dining with floor to ceiling glass sliders for in/out flow
- East to rear sunshine with tropical garden and exceptional privacy
- Family-sized kitchen, induction cooktop, oven, dishwasher, pantry cupboard
- Separate bedroom zones, two bedrooms both with built-in mirror robes

**Inspect:** Wednesday, 22nd May 2024 9:30 - 10:00  
**Auction:** 25/05/2024 11:15 am

**Price:** Auction guide \$950,000



**Sahil Kotian**

0434 172 588



**Andrew Braid**

0404 979 597

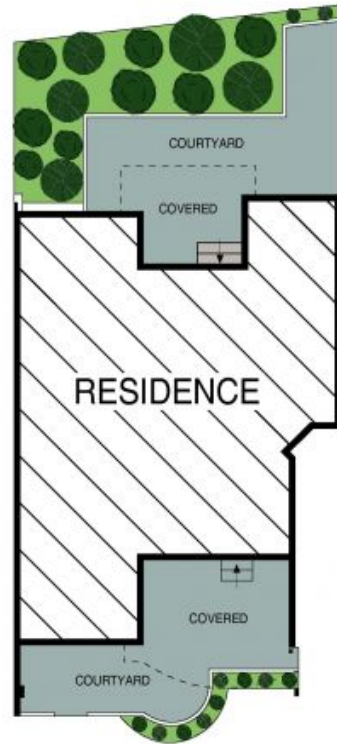

The site plan and floor plan are not to scale: measurements are indicative and in metres. Bushes and trees are placed for illustrational purposes. Plans should not be relied on. Interested parties should make and rely on their own enquiries. All information provided has been collected from reliable sources but can not be guaranteed for accuracy.