

STONE



STONE



STONE

16A The Crescent Beecroft, NSW



Modern entertainer in Beecroft public catchment

- Light-filled interiors complimented by neutral tones throughout
- High 3m ceilings, sash windows, gas outlet, reverse-cycle air-con, ducted vacuuming
- Expansive fully tiled northeast-facing alfresco entertaining terrace, ceiling with downlights, shade blinds for year-round entertaining
- Modern kitchen with stone benchtops, gas cooking and breakfast bar
- Open plan family room with brush box timber floors
- Substantial master suite with walk-in robe
- Large multi-purpose Dancing studio/entertainment downstairs
- Four-car automatic tandem garage with internal access, under-house storage

Inspect:

Saturday, 11th May 2024 11:00 - 11:30

Price: Price Guide \$2,900,000

Council Rates: \$546.40 p/q

Water Rates: \$171.41 p/q

**Brian Kong**

0435 333 383

**Kevin Dearlove**

0403 338 302

16A The Crescent, Beecroft

4 2 4 250m² 832m²

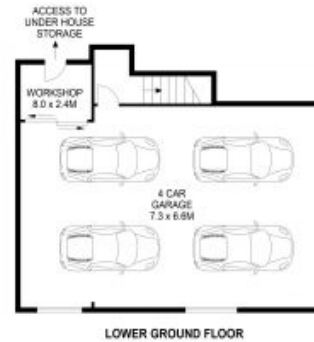

THIS IS AN ARTIST'S IMPRESSION - ALL DIMENSIONS, LAYOUTS AND TREES ARE APPROXIMATE
ALL INTERESTED PARTIES SHOULD MAKE AND RELY ON THEIR OWN ENQUIRIES

