

The logo for STONE real estate, featuring the word "STONE" in a bold, sans-serif font inside a white rectangular box with a speech bubble tail pointing towards the bottom right.

68 Connemarra Street Bexley, NSW

6 

5 

2 

## Glamorous Near-New Triple Occupancy Residence

Multi-generational families take note of this wonderful opportunity to live in poolside luxury, with ample space for both privacy and large gatherings.

The recently built solid brick home has a self-contained three-bedroom open-plan residence on each of its two main floors, plus a self-contained studio or rumpus room on the lower-ground level.

Taking advantage of the sundrenched north-westerly rear aspect, each residence extends onto a covered outdoor patio, complete with alfresco kitchen, overlooking the sparkling inground pool and good-sized lawn.

Whatever your family dynamic, this is a place grow and thrive in a peaceful locale, just 950 metres from trains, shops and dining at Kogarah CBD.

- Two spacious open-plan residences and a self-contained studio
- Open-plan living on each floor flows to alfresco area with outdoor kitchen
- LUG plus driveway parking
- High-quality contemporary finishes include tiles, stone benchtops, ducted AC and downlig...

**Inspect:** Saturday, 11th May 2024 10:15 - 10:45

**Price:** FOR SALE | \$2,850,000



**Sam Abbas**

0406 750 075

**Melanie Marques**

0402 350 734

[www.stonerealestate.com.au](http://www.stonerealestate.com.au)



Lower Ground Floor



Ground Floor



First Floor



The floor plan is not to scale; measurements are indicative and in metres. All features included in this 3D plan are for inspiration purposes only. This is not an exact replica of the property or the position of exterior elements. Plans should not be relied on. Interested parties should make and rely on their own enquiries.



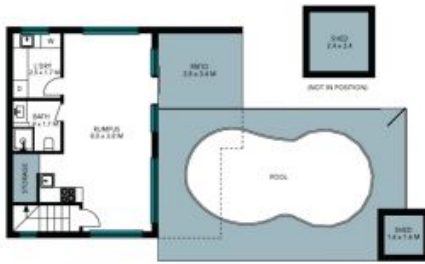

Lower Ground Floor

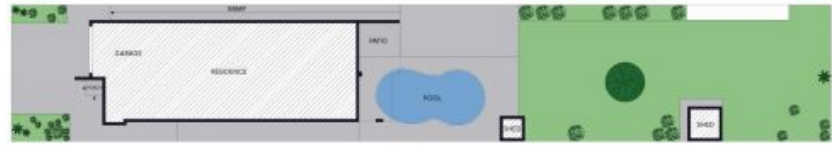

Site Plan



Ground Floor



First Floor



The site plan and floor plan are not to scale; measurements are indicative and in metres. Bushes and trees are placed for illustration purposes. Plans should not be relied on. Interested parties should make and rely on their own enquiries. All other information provided has been collected from reliable sources but cannot be guaranteed for accuracy.