

Level 20/2004/9 Brodie Spark Drive Wolli Creek, NSW

2 1 2 1

**Water view 2 bedroom + study apartment in super convenient location**

Situated on Level 20 with stunning views across local parklands, Cooks River, and Botany Bay. A minute walk to Wolli Creek Station provides a life of convenience - restaurants, grocers and retail outlets all on your doorstep. Resort style facilities for residents to enjoy - including multiple indoor/outdoor pools, gyms, BBQ areas, community and media room. A property of stunning views, space and design, this modern two bedroom + study is among the most impressive apartments in Wolli Creek.

**Price:** \$690 pw  
**Available Date:** 12/01/2022

**Stone Real Estate -  
Head Office**



**ICON**



**APARTMENT:** 1904, 2004

**LEVEL:** 19, 20

**TYPE:** 2 BED, 2 BATH

**UNIT AREA:** ( sq.m )

**INTERNAL:** 82 m<sup>2</sup>

**BALCONY:** 7 m<sup>2</sup>

**TOTAL:** 89 m<sup>2</sup>

**SHEET NUMBER:** 13.19.04C **REVISION:** D



KEY PLAN

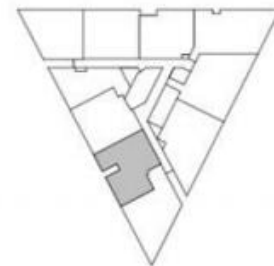

- LEGEND:**  
 C - CLIPBOARDS  
 P - PANTRY  
 R - ROSE  
 S - STORAGE  
 AC - AIR CONDITIONING UNIT  
 --- BUILDING/AWNING BELOW  
 - - - BUILDING/AWNING OVER  
 - - - BUILDING/AWNING OVER & BELOW  
 - - - SKYLIGHT OVER

DISCLAIMER: Please note that the layout plan was produced prior to construction. The information is believed to be correct but is not guaranteed. Changes may be made during construction and dimensions, areas, fittings, finishes and specification are subject to change without notice in accordance with the provisions of the contract for sale. The furniture and furnishings depicted are not included with any sale and purchases must refer to their contact for sale for the list of inclusions. The position of the furniture and furnishings should not be taken to be indicative of final positions of power points, tv connection points and the like. Prospective purchases must reply on their own enquiries. All graphics including tile layout and balustrades and the like are indicative only. NBN units and bulkheads for services not depicted.