



22/11 Wimmera Street Harrison, ACT

3 

2 

2 

Easy, Comfortable and Contemporary Living in Northern Canberra

Nestled in a sought-after location, this residence offers more than just a place to call home—it offers a lifestyle of comfort, convenience, and ease. With its thoughtful design and emphasis on functional living, this property provides the perfect backdrop for creating cherished memories and embracing the essence of suburban living at its finest.

Features Overview:

- North-West facing
- Located just moments to shops, cafes, restaurants, and Light Rail Station
- NBN connected with Fibre to the Premises (FTTP)
- Age: 9 years (built in 2015)
- EER (Energy Efficiency Rating): 6.0 Stars

Sizes (Approx.)

- Internal Living: 87 sqm
- Balcony 1: 11 sqm

Price:

\$579,000+



Jess Doolan

0477 775 773



Alex Ford

0487 382 549

22/11 Wimmera Street
Harrison



First Floor



The floor plan is not to scale; measurements are indicative and in metres. All features included in this 3D plan are for inspiration purposes only. This is not an exact replica of the property or the position of exterior elements. Plans should not be relied on. Interested parties should make and rely on their own enquiries.

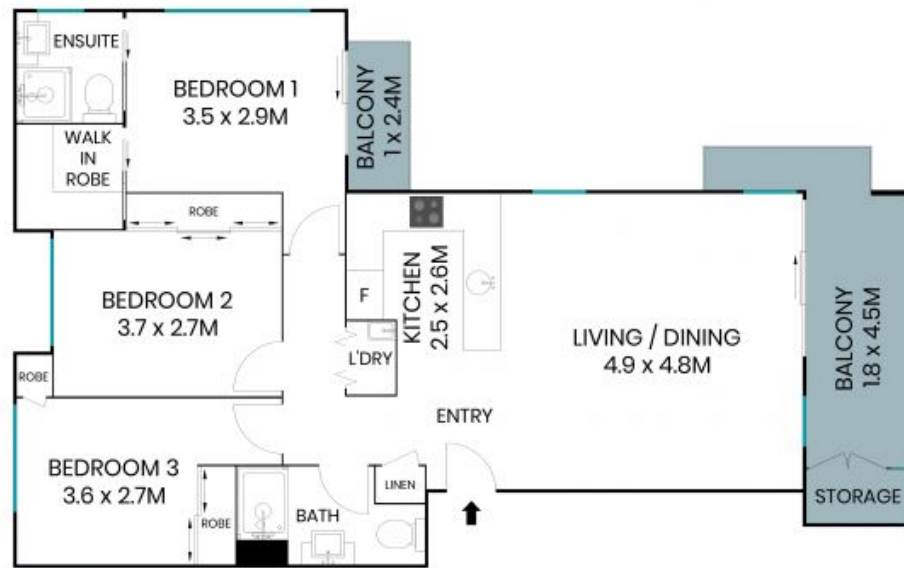

First Floor



The site plan and floor plan are not to scale; measurements are indicative and in metres. Bushes and trees are placed for illustration purposes. Plans should not be relied on. Interested parties should make and rely on their own enquiries. All other information provided has been collected from reliable sources but cannot be guaranteed for accuracy.