



11 Cosme Place Bridgeman Downs, QLD



Rare find lowset on big level block.

Located in a much sought after pocket of Bridgeman Downs this incredible home offers spacious family living across a generous single level floorplan. This beautiful home offers everything that you could want including open plan living, double garage & private outdoor living overlooking the incredible flat yard with space for the kids to play & more, it truly is a rare find.

- Sprawling 749sqm block
- Quiet cul-de-sac location surrounded by bushland and parks
- Low maintenance living
- Multiple living areas to suit the whole family
- Security screens throughout & Ducted vacuum
- Water tank & Garden shed/workshop
- Potential parking for caravan or boat
- McDowall State School catchment

This home offers:

Price:

For Sale Now



John Bradley

0410 454 718



Matthew Biggs

0499 498 988

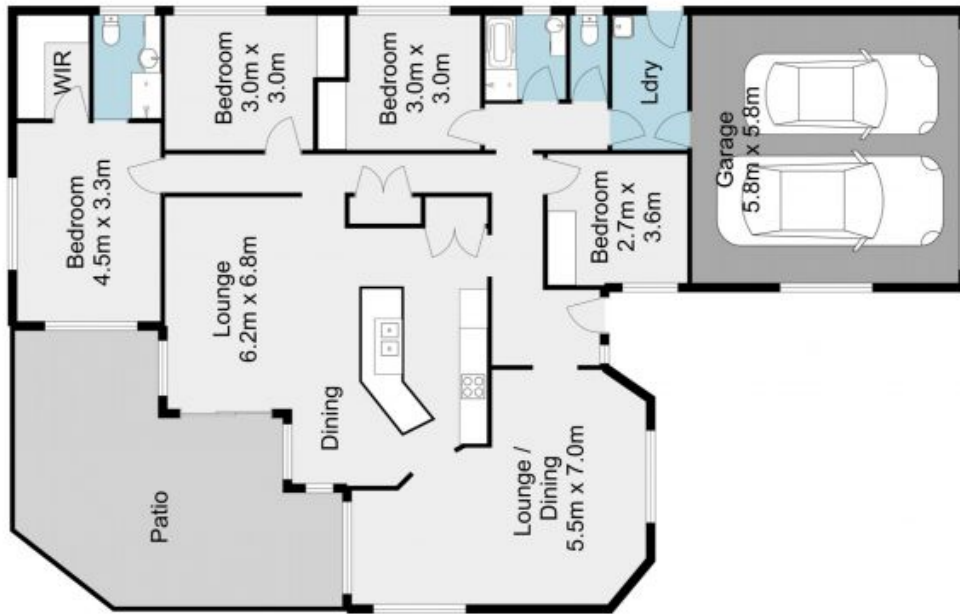

The site plan and floorplan are not to scale; measurements are indicative and in metres. Bushes and trees are placed for illustration purposes. Plans should not be relied on. Interested parties should make and rely on their own enquiries.

11 Cosme Place, Bridgeman Downs

stonespley.com.au