



A610/147 Great Western Highway Mays Hill, NSW



Top Floor Penthouse Style Apartment with Stunning City Views

Perched on the top floor of a sought after secure building, this ultra-contemporary two bedroom apartment showcases incredible city views & luxurious finishes. You will find yourself situated within minutes to Parramatta Bus & Rail Interchange, Westfield Shoppingtown, Westmead medical precinct, quality schools, vibrant restaurants/cafes, parks and sporting facilities including Parramatta Park and within easy access to the M4 Motorway and Great Western Highway.

- Stunning gas kitchen featuring 40mm stone benchtops with a waterfall edge, stainless steel appliances, breakfast bar & feature lighting
- Spacious open plan lounge & dining area with effortless flow to the spacious entertainers balcony which spans the length of the apartment
- Two generous bedrooms with direct access to the balcony & built-in mirrored wardrobes, master bedroom features an en-suite with floor to ceiling tiles & mirrored built-in storage
- Stylish, fully tiled bathrooms with frameless shower screens

Price:

UNDER CONTRACT



Aaron Lih
0420 825 598



Nicola Reilly
0405 203 525

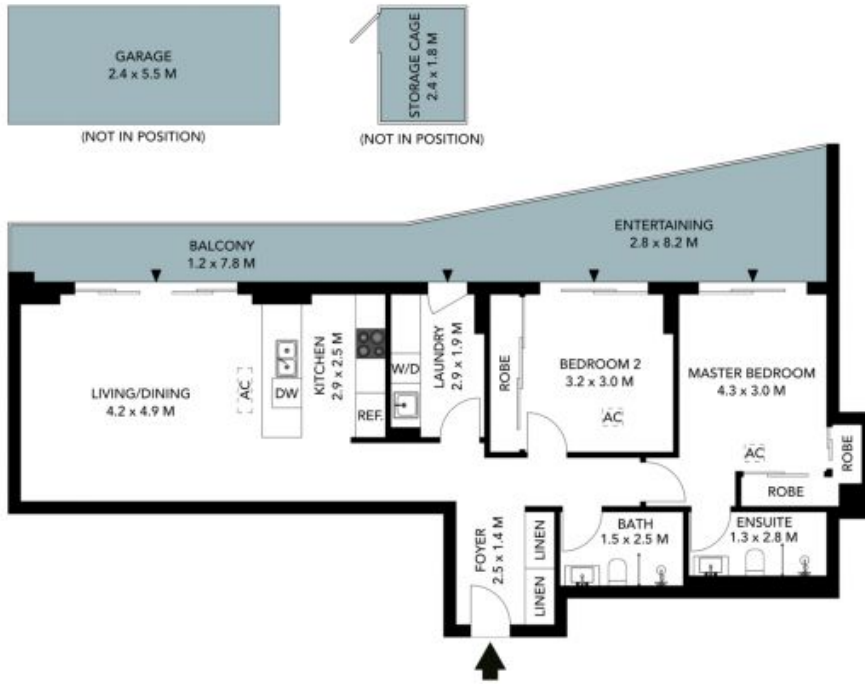

The floor plan is not to scale, measurements are indicative and in metres. Exterior elements are not in position. Plans should not be relied on, interested parties should make and rely on their own enquiries. All other information provided has been collected from reliable sources but cannot be guaranteed for accuracy.

A610/147 Great Western Highway
Mays Hill

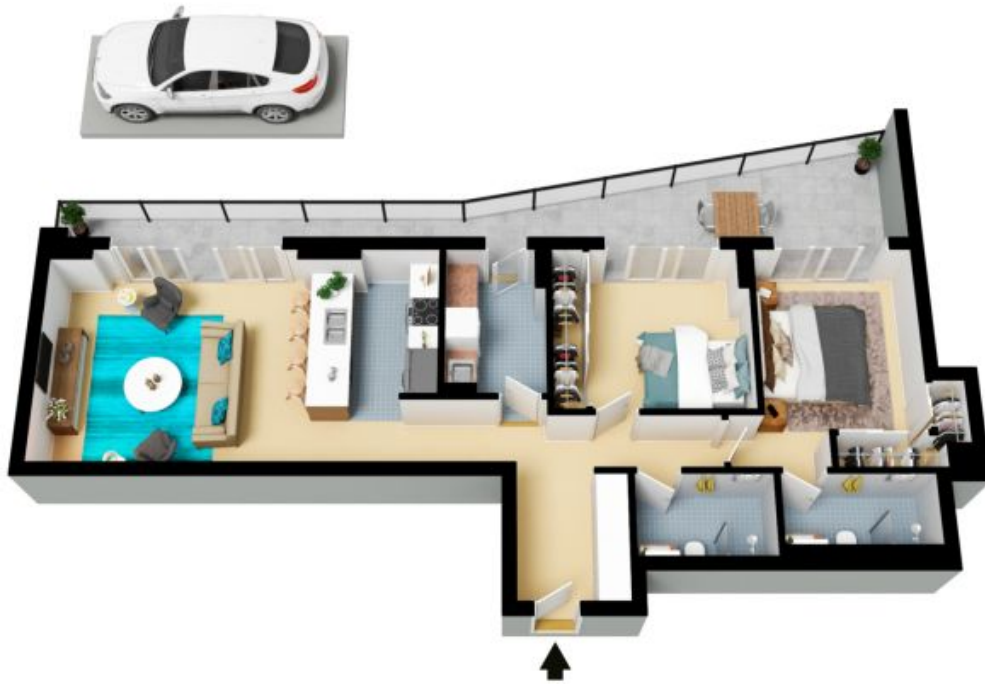

The floor plan is not to scale; measurements are indicative and in metres. All features included in this 3D plan are for inspiration purposes only. This is not an exact replica of the property or the position of exterior elements. Plans should not be relied on. Interested parties should make and rely on their own enquiries.