



3/642 Pacific Highway Killara, NSW



Incredibly tranquil off-highway position with walk to rail.

Immersed in northeast sunlight and manicured garden views, this large double brick Art Deco strata apartment offers fantastic value with its outstanding walk to rail convenience. Interiors offer a generous 87sqm of single level space, rich in character.

Showcasing European flare, the integrated lounge and dining has a gas fireplace flanked by twin windows and adjoins the well-appointed kitchen. Two vast bedrooms provide excellent storage while sharing an elegant bathroom, plus there's an internal laundry. 700m to Killara Station. In Killara Public and Killara High School zones.

- House-like apartment in block of ten, offered for the first time in 39 years
- Away from the highway, wrapped in absolutely stunning landscaped gardens
- 87sqm approx. interior layout with easy near-level access from the main entry
- Spacious lounge and dining, pretty mullioned windows frame the garden view
- Kitchen with cooktop, oven, dishwasher, a microwave hutch frees counter space
- Two bedrooms, king-size main and double second, both with expansive robes
- Charming bathroom, luxury alabaster accent, bath, shower, internal laundry
- On-site car space, plus easy drive in and drive out to and from the highway

Auction: 04/05/2024 03:00 pm

Price: Contact Agent



Ryan Woo

0410 884 680



Andrew Braid

0404 979 597

3/642 Pacific Highway,
Killara

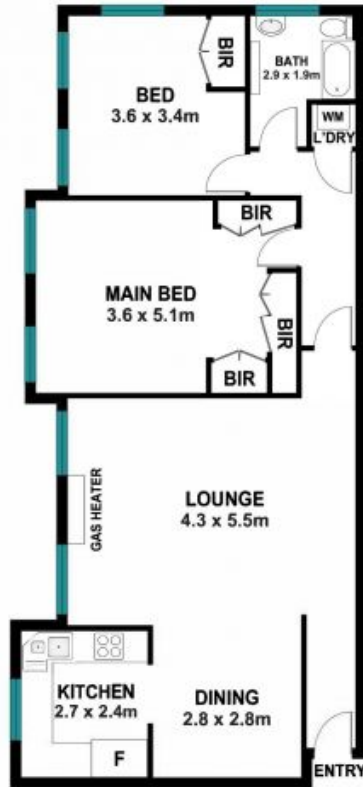

The site plan and floor plan are not to scale; measurements are indicative and in metres. Bushes and trees are placed for illustration purposes. Plans should not be relied on. Interested parties should make and rely on their own enquiries. All other information provided has been collected from reliable sources but cannot be guaranteed for accuracy.