



10 Bellebrae Avenue Mount Ousley, NSW



SOLD BY STONE REAL ESTATE | DARNELL HASELAU & EMILY BOLTON

Price:

Contact Agent

Absolute charm and family comfort on an expansive parcel of land



Darnell Haselau

0426 400 240



Emily Bolton

0437 774 036

10 Bellebrae Avenue
Mount Ousley



Lower Ground Floor

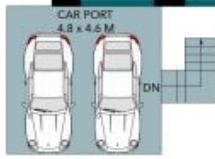

Ground Floor



Site Plan



The site plan and floor plan are not to scale; measurements are indicative and in metres. Bushes and trees are placed for illustration purposes. Plans should not be relied on. Interested parties should make and rely on their own enquiries. All other information provided has been collected from reliable sources but cannot be guaranteed for accuracy.