

14 Treeview Place Mardi, NSW

4

2

2

## The Perfect Family Haven

Welcome to your dream family home nestled in a warm and welcoming, family-friendly neighbourhood. This charming residence offers comfort, space, and a strong sense of community. With four bedrooms, multiple living areas, and a beautiful backyard, it's the perfect haven for a growing family.

As you approach the property, you'll be immediately struck by its exceptional street appeal. The front of the house is adorned with landscaped gardens, showcasing a riot of colors and greenery, adding a touch of natural beauty to the suburban setting. The well-maintained exterior exudes a sense of pride in ownership, making a great first impression on anyone who passes by.

The heart of this home is the well-appointed kitchen. It features modern appliances and ample counter space making it a hub for culinary adventures and casual meals. ...

...

The four bedrooms are generously sized and offer plenty of storage space. The master bedroom comes complete with an en-suite bathroom, offering a private oasis for the homeowners. ...

**Price:**

\$950,000 - \$1,050,000



**Shanti Santhou**

0451961436

# 14 Treeview Place Mardi



Outdoor Area

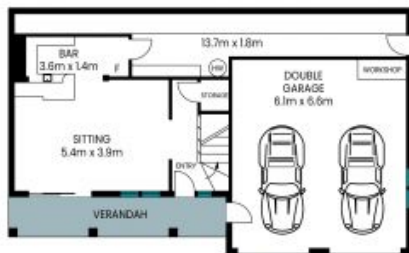

Ground Floor



First Floor



Site Plan

Internal Area: 190 sqm  
External Area: 51 sqm  
Garage Area: 40 sqm  
Land Area: 753 sqm

PLEASE NOTE: These Floor and Site Plans have been generated for marketing purposes and are to be used as a guide only. While all care is taken, no guarantee can be given in respect of accuracy, sizes and dimensions are approximate, actual may vary.

