

9/5 Hollylea Road Leumeah, NSW

### Bulky Retail Complex

Located in the popular bulky retail complex on Hollylea Road and surrounded by various well known occupiers such as BBQ Galore, Red Rooster and Independent Carpets.

Situated parallel to Campbelltown Road the property is only minutes walk to Leumeah Train Station and less than 2 kilometres to the M5 Motorway.

Improvements consist of; Container height roller door - Ample onsite parking An opportunity exists for a prominent occupier to establish themselves in the heart of Macarthur's bulky goods precinct.

- \* Total building area approx. 440m<sup>2</sup>
- \* Access via a container height roller shutter door
- \* Mezzanine level with ground floor amenities
- \* Located at a small complex
- \* Complex offers good vehicle access
- \* Container height roller door
- \* Ample onsite parking



**Evan Skagias**

0405 588 885



**Harry Karafotias**

0418 116 147

9/5 Hollylea Road  
Leumeah

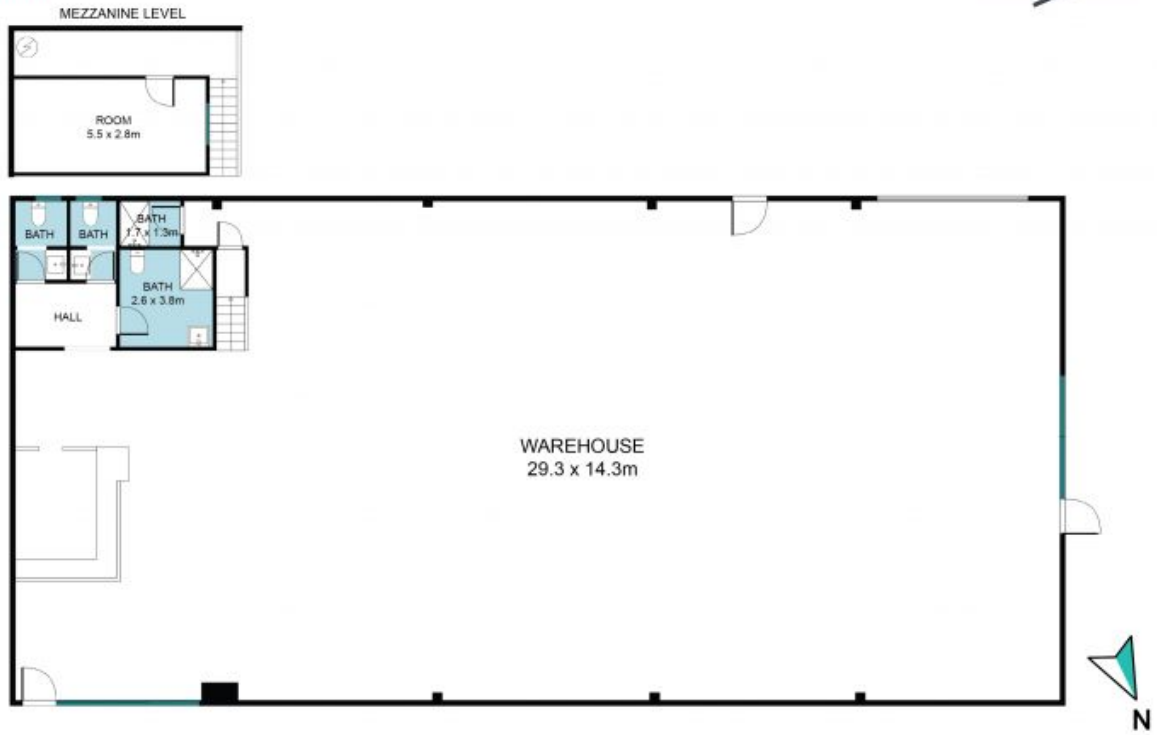

The site plan and floor plan are not to scale; measurements are indicative and in metres. Bushes and trees are placed for illustration purposes. Plans should not be relied on. Interested parties should make and rely on their own enquiries. All other information provided has been collected from reliable sources but cannot be guaranteed for accuracy.