



11/122 Bower Street Manly, NSW

3

2

1

Breathtaking Panoramic Views

- Modern kitchen and with eat-in island, dishwasher, and ample storage
- Large open-plan living area flowing to North-east facing balcony
- Sweeping views that stretch across the Northern Beaches Coastline to Palm Beach
- Generous sized bedrooms, two with stunning ocean views
- Main bedroom has a sleek ensuite and built-in wardrobe and breathtaking views
- Modern bathrooms with oversized walk-in showers, separate toilet off main bathroom
- Remote lock up garage, large Internal laundry with bonus drying rack and loads of storage
- Schlage digital door lock system for keyless entry

Price: \$7,000,000



Tim Mumford

0421 942 693



Catherine Wilson

0421 966 570

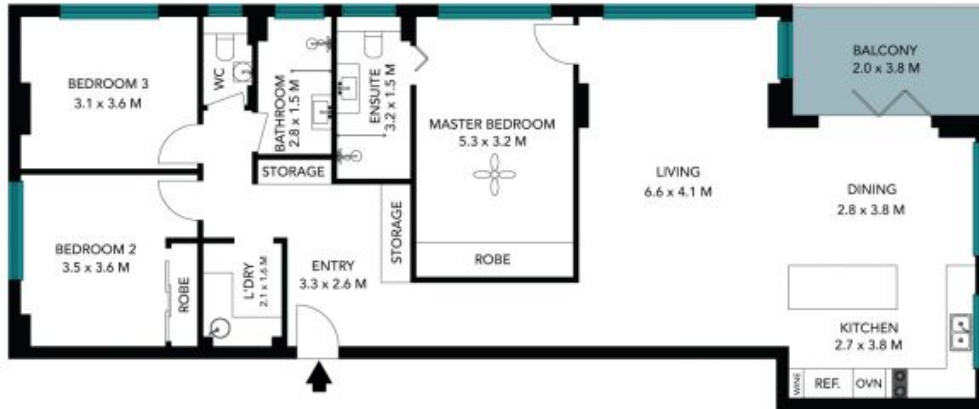

The floor plan is not to scale, measurements are indicative and in metres. Certain elements are not in position. Plans should not be relied on. Interested parties should make and rely on their own enquiries. All other information provided has been collected from reliable sources but cannot be guaranteed for accuracy.

11/122 Bower Street
Manly



The floor plan is not to scale; measurements are indicative and in metres. All features included in this 3D plan are for inspiration purposes only. This is not an exact replica of the property or the position of exterior elements. Plans should not be relied on. Interested parties should make and rely on their own enquiries.