



77 Chapman Street Gymea, NSW

5

4

3

## Huge Family Home in Convenient Locale

Conveniently located in a family-friendly street, in proximity to Gymea Village and train station, this huge family home offers multiple living and dining zones as well as five sizeable bedrooms ideal for the growing or extended family. It offers additional entertaining space outside including a separate rumpus, alfresco zone and massive inground pool, plus potential for self-contained accommodation. Plenty of space for the family to enjoy and all just minutes from local schools, Village shops, cafes and restaurants, transport, and Westfield Miranda.

### Features include:

- Main bedroom with ensuite and walk-in wardrobe
- Three more bedrooms all with built-in wardrobes
- Large study or fifth bedroom with separate entry
- Open plan kitchen and dining room
- Modern kitchen with stone benchtops, glass splashbacks, ceramic cooktop, dishwasher and a corner pantry
- Second lounge, ideal for teens, guests or extended family

**Price:** \$1200 Per Week

**Bond:** \$4,800

**Available Date:** 25/04/2024



**Saskia Roberts**

0491 168 530



**Daniel Pirie**

02 9526 2000

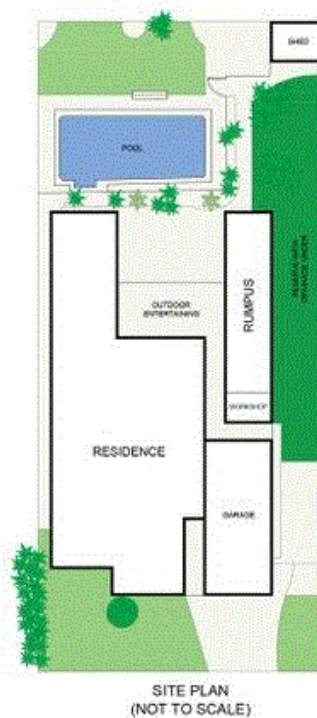

## 77 Chapman Street, Gympie

Scale in metres. Indicative only. Dimensions are approximate. All information contained herein is gathered from sources we believe to be reliable. However, we cannot guarantee its accuracy and interested persons should rely on their own enquiries. Some images may contain digital furniture.