

City views from current dwelling



69 Kuran Street Chermside, QLD



Park View, City View

Positioned a mere 50 metres from the Wavell Heights border, this post war gem is the jewel in the crown and rests on a 524sqm corner block. This home is immediately livable yet has so much scope to expand and grow later. Just moments to parks, shops, and schools, this home's potential is only rivalled by its incredible position and size.

- 524sqm corner block
- City and Mt. Coot-tha Views
- North / South facing aspect
- Bernie Brae park at your front door
- Neat as a pin original family home
- Family friendly floorplan
- Huge under house storage
- Wheel chair accessible ramp to property

Price:

For Sale Now



Tristan Rowland

0411 572 970

LEVEL 1	93 SQM
LEVEL 2	103 SQM
LEVEL 3	34 SQM
EXTERNAL	42 SQM
TOTAL	272 SQM

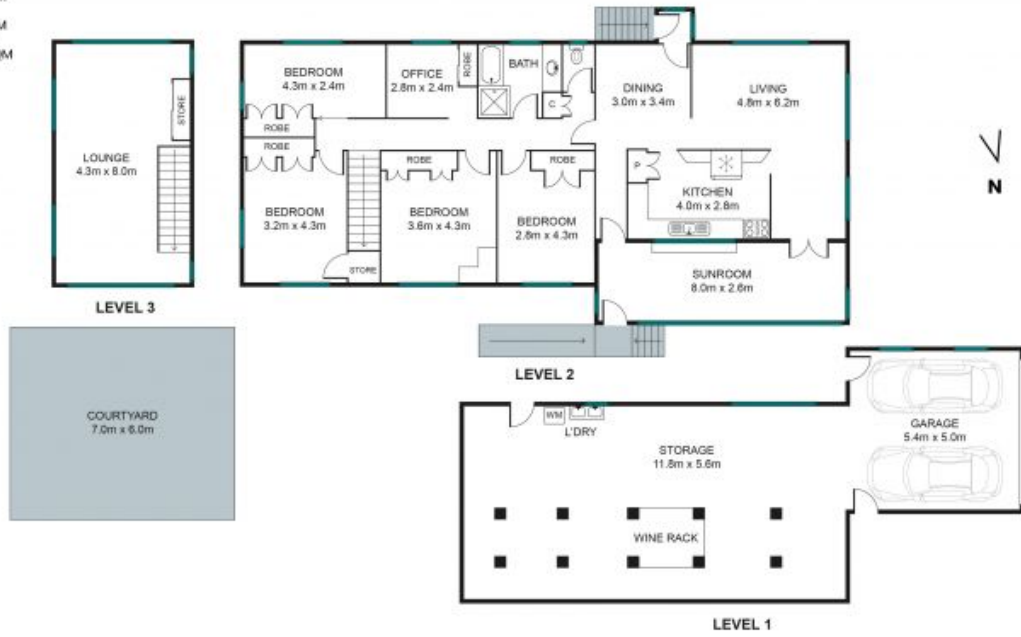

The site plan and floor plan are not to scale, measurements are indicative and in metres. Bushes and trees are placed for illustration purposes. Plans should not be relied on. Interested parties should make and rely on their own enquiries.

69 Kuran Street, Chermside

Stoneaspley.com.au

