



2 Tamworth Street Abermain, NSW



Your private and pristine oasis

With a tranquil green back drop, this secluded sanctuary offers plenty of serenity and comfortable family living. Enjoy a beautifully equipped kitchen complete with wall oven and massive corner pantry. Open and tiled living flows effortlessly to your lush green yard ? with no neighbours to see here. Showcasing multiple living areas with a versatile layout and four generous bedrooms ? the master with ensuite, walk in robe and split system air. Located at the gateway to the Hunter Valley on 1,517sqm with just 800ms to Abermain Primary School and only 7kms to both Kurri and the Hunter Expressway Interchange.

- Contemporary home set on a tranquil and serene 1,517sqm
- Kitchen with stone bench tops, feature tile splashback and massive corner pantry
- Effortlessly open living and dining with split system air and easy outdoor access
- Versatile and sprawling layout with room for everyone
- Four bedrooms, bed two with split system air and BIR ? the master with ensuite, B/in and split system air
- 47 solar panels with 10 kW battery

Inspect:

Saturday, 18th May 2024 10:00 - 10:20

Price:

\$950,000



Debra Ford

0413 478 655

2 Tamworth Street
Abermain

STONE

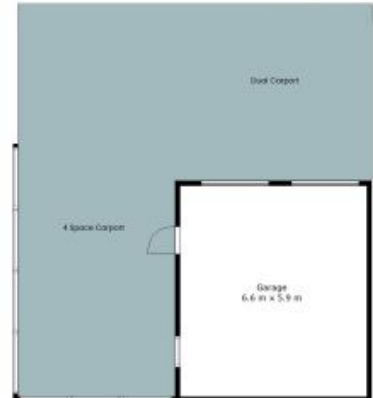

Site Map



The site plan and floor plan are not to scale; measurements are indicative and in metres. Bushes and trees are placed for illustration purposes. Plans should not be relied on. Interested parties should make and rely on their own enquiries. All other information provided has been collected from reliable sources but cannot be guaranteed for accuracy.

2 Tamworth Street
Abermain

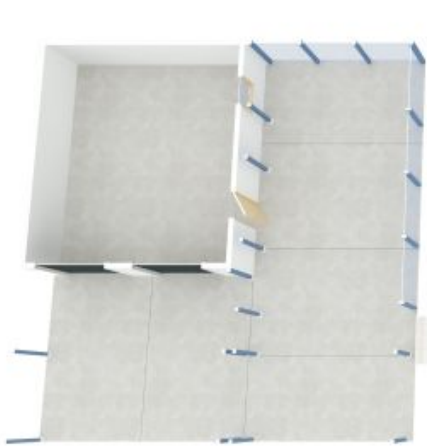

The site plan and floor plan are not to scale; measurements are indicative and in metres. Bushes and trees are placed for illustration purposes. Plans should not be relied on. Interested parties should make and rely on their own enquiries. All other information provided has been collected from reliable sources but cannot be guaranteed for accuracy.