

22 Westminster Street Bexley, NSW

5

5

2

Luxurious brand-new family abode

Indulge in a truly magnificent residence that will provide your family with elegant spaces for gathering together and retreating privately.

Boasting four ensuite bedrooms, plus a fifth bedroom, three living spaces and a sundrenched poolside oasis, the brand-new home meets the demands of family life with durable finishes and minimalistic design.

Within walking distance of trains, cafes, schools and grocers at Rockdale's village hub, the property is also a short drive from Lady Robinson's Beach and coastal promenades. Inspect and discover why savvy buyers from the inner-west and east are flocking to this high-value lifestyle locale within 12km of the CBD.

Features:

- Brand-new double-storey brick home in a quiet residential street

Inspect: Saturday, 18th May 2024 10:00 - 10:30
Auction: 01/06/2024 12:00 pm

Price: AUCTION | SAM ABBAS



Sam Abbas

0406 750 075

Melanie Marques

0402 350 734



First Floor



Ground Floor

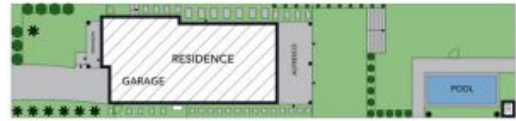

Site Plan



(NOT IN POSITION)



The site plan and floor plan are not to scale; measurements are indicative and in metres. Bushes and trees are placed for illustration purposes. Plans should not be relied on. Interested parties should make and rely on their own enquiries. All other information provided has been collected from reliable sources but cannot be guaranteed for accuracy.

22 Westminster Street
Bexley



First Floor



Ground Floor



The floor plan is not to scale; measurements are indicative and in metres. All features included in this 3D plan are for inspiration purposes only. This is not an exact replica of the property or the position of exterior elements. Plans should not be relied on. Interested parties should make and rely on their own enquiries.