



16 Geraldton Place Yarrawarra, NSW



Treetop living in a peaceful cul-de-sac location

Enjoy elevated treetop living in this quiet and peaceful family home. Split over two levels, it has a large living room that flows seamlessly out to a covered deck with stunning bush surrounds, an eat-in kitchen and a second entertaining area. A home office, four bedrooms and a swimming pool make this ideal for families. Just a short distance to shops, transport and schools, it is your own slice of paradise.

Price: Contact agent
Council Rates: \$451.60 p/q
Water Rates: \$171.41 p/q



Rhys Christofa

0415 684 877



Brayden Watson

0415 122 733

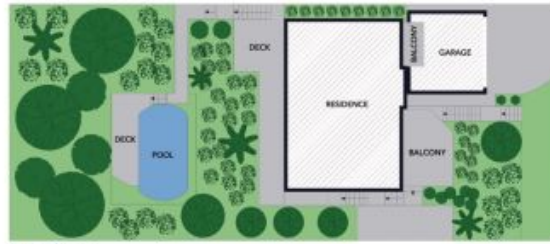

Site Plan



The site plan and floor plan are not to scale; measurements are indicative and in metres. Bushes and trees are placed for illustration purposes. Plans should not be relied on. Interested parties should make and rely on their own enquiries. All other information provided has been collected from reliable sources but cannot be guaranteed for accuracy.

16 Geraldton Place
Yarrawarrah



The floor plan is not to scale; measurements are indicative and in metres. All features included in this 3D plan are for inspiration purposes only. This is not an exact replica of the property or the position of exterior elements. Plans should not be relied on. Interested parties should make and rely on their own enquiries.