



72 Coronation Street Kurri Kurri, NSW

2 1 1

Great starter to get you into the market!

Sitting on an approximately 505sqm block (approx) with rear-lane access, this cottage effortlessly blends the classic family-friendly comfort of Kurri-Kurri, without the huge price tag. The property is surrounded by parks and reserves, and is situated just a short walk from Kurri Kurri Public School and the Kurri Kurri CBD for complete convenience.

rainfall shower tapware.

This property is also blessed with a deep and exceptionally versatile backyard, serviced by an outdoor 2nd toilet, two storage sheds, and covered carport space.

- Walking distance to local parks and playgrounds, Kurri Kurri Public School, and the CBD
- 505sqm block (approx) with front and rear-lane access; deep backyard with carport, sheds

Price: \$485,000 - \$525,000
Council Rates: \$1,800.00/year (approx)
Water Rates: \$695.00/year (approx)



Renee Bean-Wyper

0403 325 076



Jorja Pauling

02 4089 1155

72 Coronation Street
Kurri Kurri

STONE

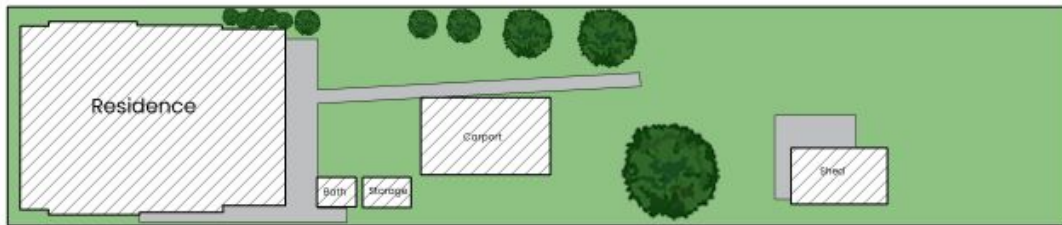

Site Map



The site plan and floor plan are not to scale; measurements are indicative and in metres. Bushes and trees are placed for illustration purposes. Plans should not be relied on. Interested parties should make and rely on their own enquiries. All other information provided has been collected from reliable sources but cannot be guaranteed for accuracy.