



Killara, NSW

4 2 2

Premier east side elegance captivates with walk to rail convenience.

This rare and sophisticated home offers the best of the North Shore, pairing a leafy north to rear setting with walk to rail convenience. Two substantial living and dining areas are enhanced by a custom granite kitchen and seamless connection to the outdoors for poolside entertaining wrapped in richly landscaped gardens. The main bedroom is a masterpiece of luxury perfect for revitalising after a long day. Walk to Killara or Gordon rail. In Killara High School zone.

Features include:

- Richly carpeted lounge, marble gas fireplace, formal dining or TV room
- Open family room + casual dining flows to alfresco entertaining and garden
- Granite and Miele kitchen, induction cooktop, grill, fryer, oven, dishwasher
- Four bedrooms, two sharing a charming sunroom, built-in robes
- Luxury master: study, sitting area, balcony, walk-in robe, marble ensuite
- Beautifully appointed bathrooms, marble finishes, bath, double vanity
- Landscaped alfresco entertaining areas sun-kissed from north orientation

Price: \$1950 per week
Available Date: 03/05/2024



Stephanie Ryan

0451 307 760



Chase Kuo

0466 363 140

6 Elva Avenue
Killara

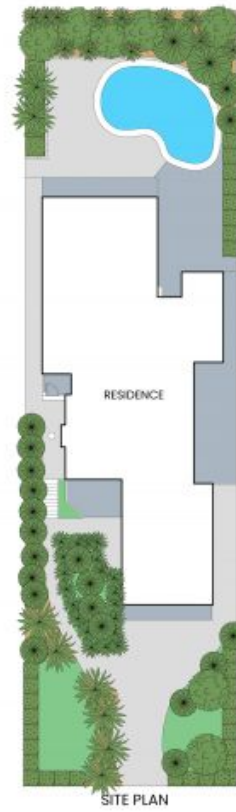
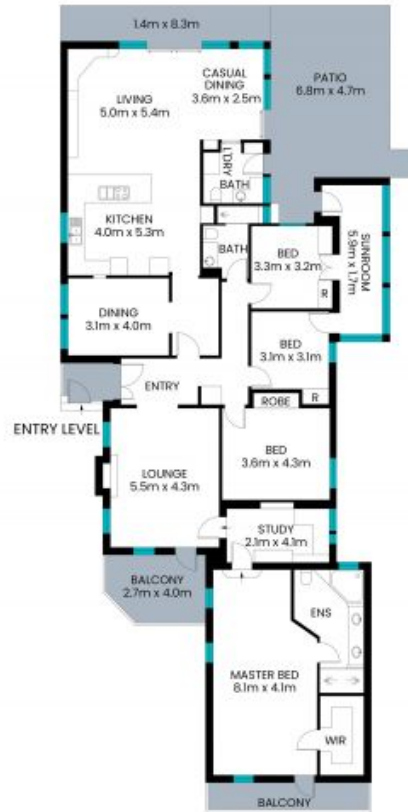

STONE



Internal area: 295m²
External area: 70m²
Total area (approx.): 365m²

The site plan and floor plan are not to scale; measurements are indicative and in meters. Bushes and trees are placed for illustration purposes. Plans should not be relied on. Interested parties should make and rely on their own enquiry. All other information provided has been collected from reliable sources but cannot be guaranteed for accuracy.