

35 Parkridge Drive Jilliby, NSW

4

2

4

### Oasis on Parkridge Drive!

Welcome to your dream family home! Positioned on Jilliby's picturesque Parkridge Drive amongst other quality acreage properties, if you're looking for a quiet place to retreat and rest from the world yet would still like to be close to the M1 and Westfield Tuggerah, as well as the beach and quality schools, then this is it!

This beautifully presented residence flows over a light-filled single level capturing scenic green views on one usable hectare (2.5 acres). Featuring four spacious bedrooms, two bathrooms, including a walk-in robe and ensuite in main bedroom. This home is perfect for family living with open plan kitchen and dining and an extra rumpus room! Slow combustion fireplace for those cozy winter nights.

All your parking needs are covered too with a double lock up garage under the home's roofline and large shed that allows you to store all your equipment and tools....

...

**Inspect:** Saturday, 25th May 2024 12:45 - 1:30

**Price:** New To Market



**Scott Wall**

0413 965 616



**Kaela Wall**

0434726944

# 35 Parkridge Drive Jilliby

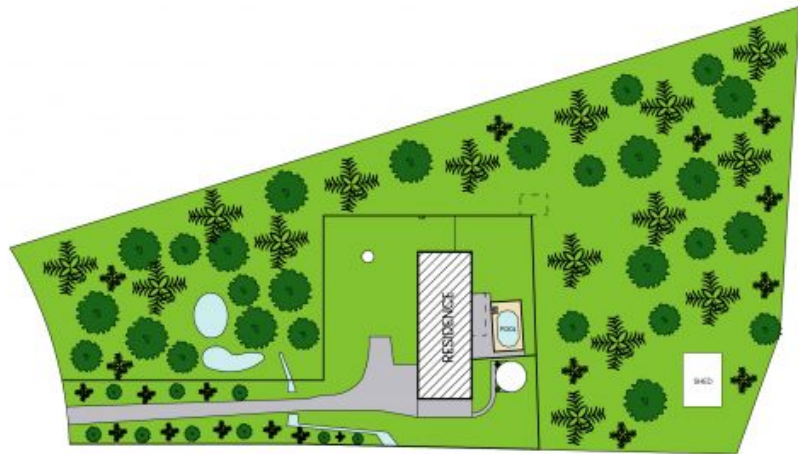

Internal Area: 166 sqm

PLEASE NOTE: These Floor and Site Plans have been generated for marketing purposes and are to be used as a guide only. While all care is taken, no guarantee can be given in respect of accuracy, sizes and dimensions are approximate, actual may vary.

