



32/1 Addison Road Manly, NSW



Premier setting with captivating 180-degree views across Sydney Harbour

Anchored to the very tip of Manly Point, this absolute harbourfront security apartment is immersed in a simply breathtaking panoramas that takes in uninterrupted harbour views. Renovated throughout this stunning apartment is exceptionally located only a short stroll to Little Manly Beach and a few moments' walk to the Manly Ferry Wharf, restaurants, cafes, entertainment.

Price:

Contact Agent



Tim Mumford

0421 942 693



Catherine Wilson

0421 966 570

32/1 Addison Road
Manly

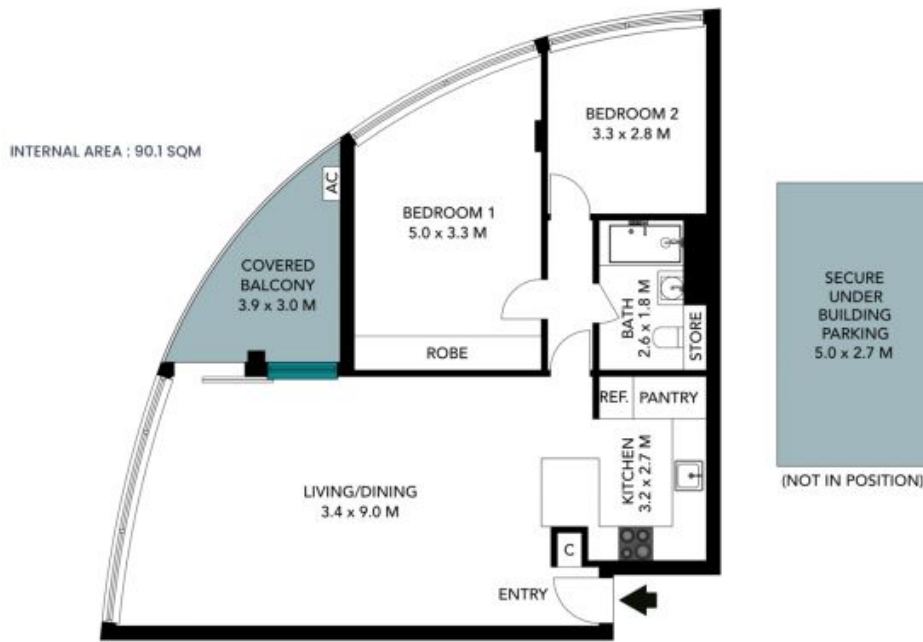

The floor plan is not to scale, measurements are indicative and in metres. Exterior elements are not in position. Plans should not be relied on, interested parties should make and rely on their own enquiries. All other information provided has been collected from reliable sources but cannot be guaranteed for accuracy.

32/1 Addison Road
Manly



INTERNAL AREA : 90.1 SQM



The floor plan is not to scale; measurements are indicative and in metres. All features included in this 3D plan are for inspiration purposes only. This is not an exact replica of the property or the position of exterior elements. Plans should not be relied on. Interested parties should make and rely on their own enquiries.