



13/35 Darley Street East Mona Vale, NSW



### Enticing coastal enclave just 250metres from the beach

If you love the ocean, the beach and a round of golf, all at your doorstep, look no further - this is the ideal place to be for you. Boasting a bright and airy position with a sun kissed northerly aspect and located just 250m from Mona Vale Beach, this stunning top floor apartment offers the perfect mix of style and position in a sought-after beachside part of Mona Vale.

**Price:** SOLD \$1,090,000  
**Council Rates:** \$404.00 p/q  
**Water Rates:** \$171.00 p/q  
**Strata Rates:** \$1,686.00 p/q



**Judy Fitzgerald**

0422 651 655



**Kieran Fitzgerald**

0435 714 947

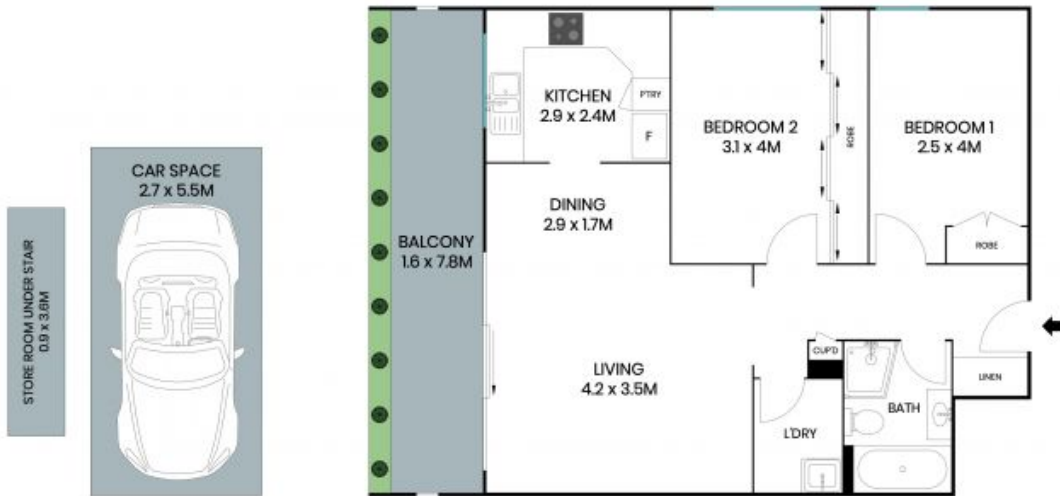

The site plan and floor plan are not to scale; measurements are accurate and in metres. Bushes and trees are placed for illustration purposes. Plans should not be relied on. Interested parties should make and rely on their own enquiries. All other information provided has been collected from reliable sources but cannot be guaranteed for accuracy.