



163/1 Mouat Street Lyneham, ACT

2

1

1

Contemporary And Convenient Urban Living In Canberra's Inner-North

Secure your spot in one of Canberra's prime inner-North residences with this elegant 2-bedroom apartment in the perfectly-situated Axis complex in Lyneham. Boasting white walls, a cohesive semi-modern aesthetic, and expansive floor-to-ceiling windows leading to the balcony, this home is bathed in natural light and showcases a sleek, contemporary design.

Price: \$520,000



Sam Dyne

0488 689 525



Basement



Level Seven



The site plan and floor plan are not to scale; measurements are indicative and in metres. Bushes and trees are placed for illustration purposes. Plans should not be relied on. Interested parties should make and rely on their own enquiries. All other information provided has been collected from reliable sources but cannot be guaranteed for accuracy.

163/1 Mouat Street
Lyneham

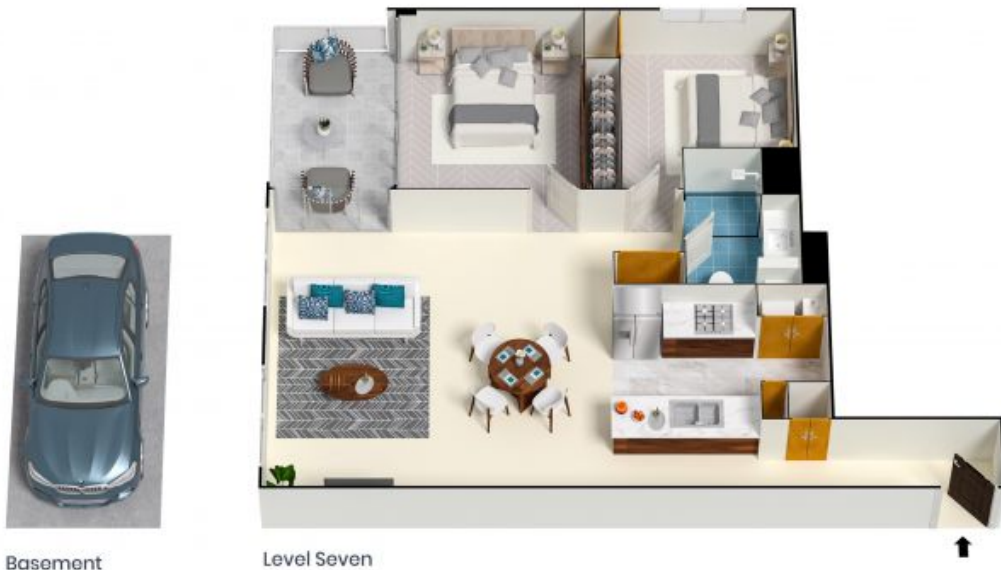

Basement

Level Seven



The floor plan is not to scale; measurements are indicative and in metres. All features included in this 3D plan are for inspiration purposes only. This is not an exact replica of the property or the position of exterior elements. Plans should not be relied on. Interested parties should make and rely on their own enquiries.