



13 Kingsford Smith Drive Berkeley Vale, NSW

4

2

2

**This one will not last!**

Welcome to this impressive single level home in the popular suburb of Berkeley Vale. Perfect for the growing family looking for a spacious home with four bedrooms and spacious living areas plus a great outdoor entertaining area overlooking the level backyard, large garage and in-ground pool!

**Price:** \$790,000



**Volkan Akintetik**

0499 830 247



**Reece Caira**

0431 013 342

13 Kingsford Smith Drive  
Berkeley Vale

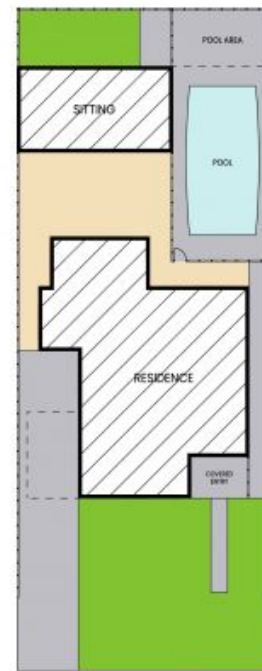

Site Plan

Internal Area: 139 sqm  
External Area: 52 sqm  
Total Area: 191 sqm

PLEASE NOTE: These Floor and Site Plans have been generated for marketing purposes and are to be used as a guide only. While all care is taken, no guarantee can be given in respect of accuracy, sizes and dimensions are approximate, actual may vary

