



21A Kingslangley Road Greenwich, NSW



Charming Garden Studio

Located in a quiet and leafy neighbourhood this wonderfully secluded open plan studio is bathed in natural light

Price: LEASED - \$385 per week

Bond: \$1,540

Available Date: 15/07/2024



Jaydn Frintzilas

0468 998 294



William Pendrick

0434 808 385

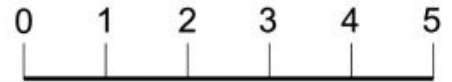
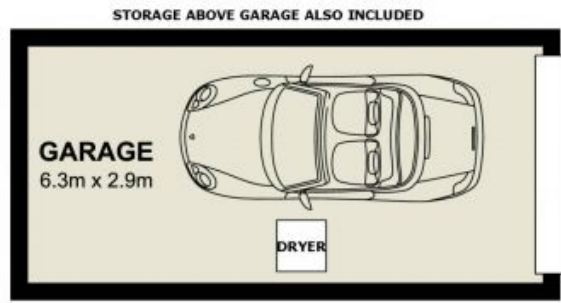
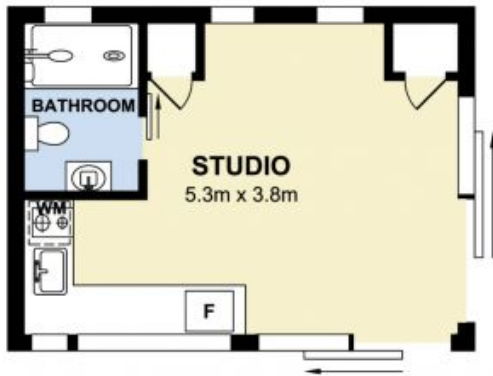

21A Kingslangley Road, Greenwich

Measurements are approximate. Not to scale. Illustrative purposes only.
We do not take any responsibility for any information supplied.

