



516/51-54 The Esplanade Ettalong Beach, NSW



### Level 5 Resort Apartment

Positioned on level 5 opposite the beach with water views is this fully furnished resort apartment. In the heart of Ettalong beach with an east facing balcony overlooking the pool with views towards Wagstaffe and offering all the luxuries of resort style living this unit is an ideal getaway for yourself and your guests.

**Price:** \$565,000  
**Council Rates:** \$1,169.97/year (approx)  
**Water Rates:** \$1,062.99/year (approx)  
**Strata Rates:** \$4,974.40/year (approx)



**Christel Renton**

0417 208 314



**Lian O'Grady**

0423 688 275

516/51-54 The Esplanade,  
Ettalong Beach

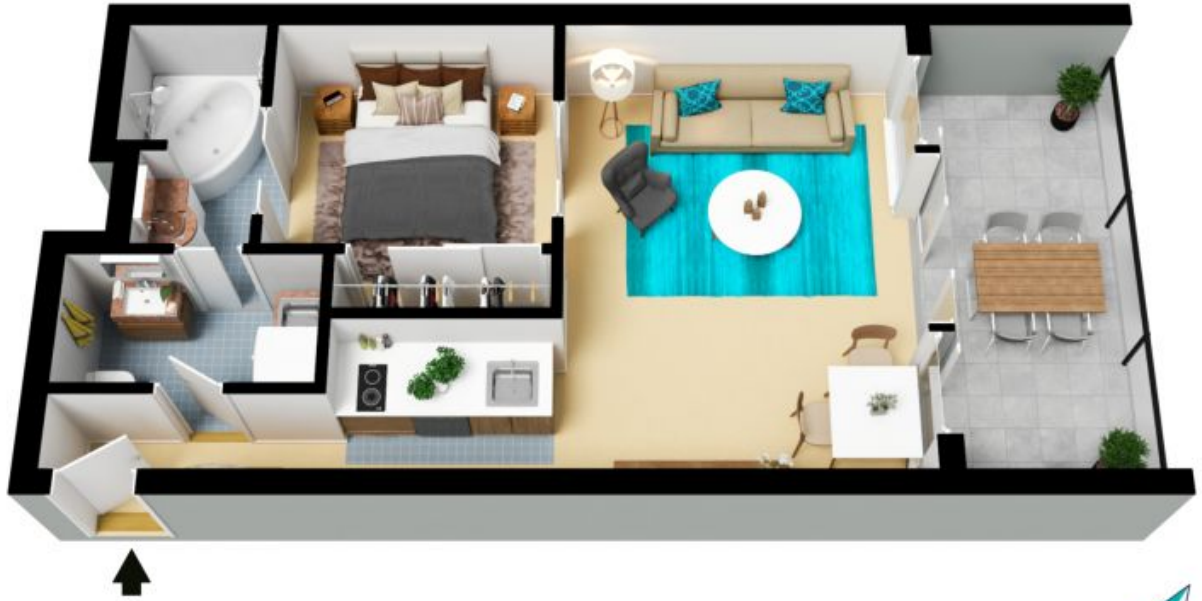

The floor plan is not to scale; measurements are indicative and in metres. All features included in this 3D plan are for inspiration purposes only. This is not an exact replica of the property or the position of exterior elements. Plans should not be relied on. Interested parties should make and rely on their own enquiries.

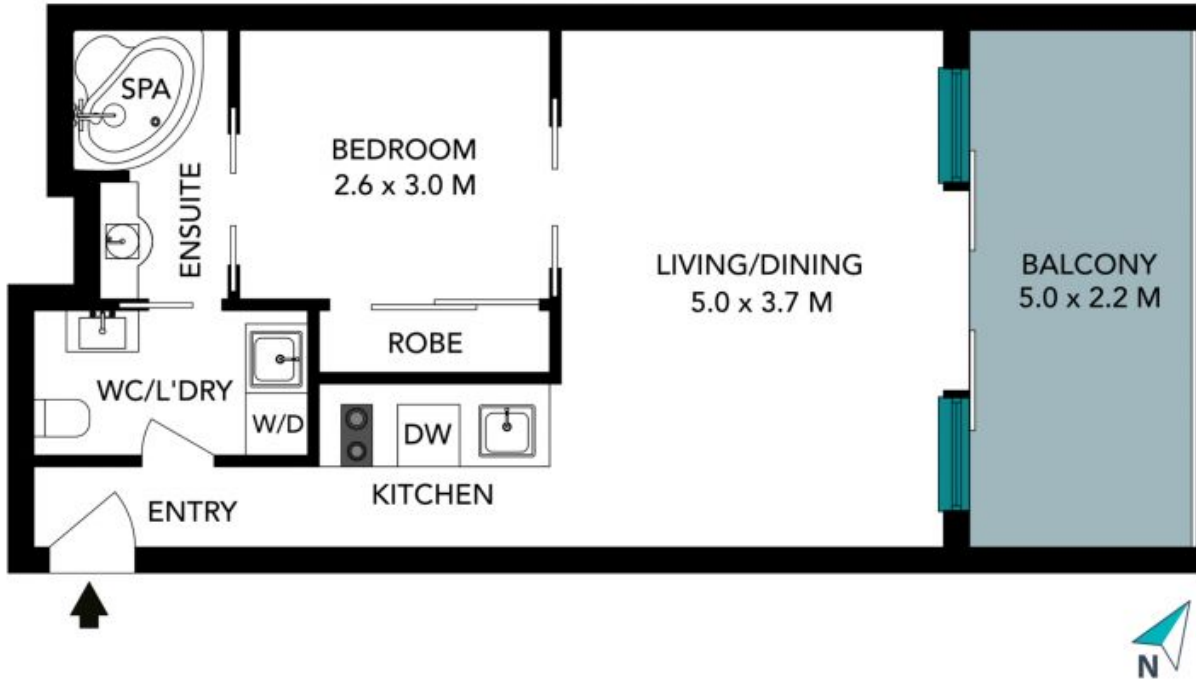

The floor plan is not to scale, measurements are indicative and in metres. Exterior elements are not in position. Plans should not be relied on, interested parties should make and rely on their own enquiries. All other information provided has been collected from reliable sources but cannot be guaranteed for accuracy.