



13/35-43 Dalley Street Queenscliff, NSW



Spacious luxury living

Price:

Contact Agent



Catherine Wilson

0421 966 570

13/35-43 Dalley Street
Queenscliff

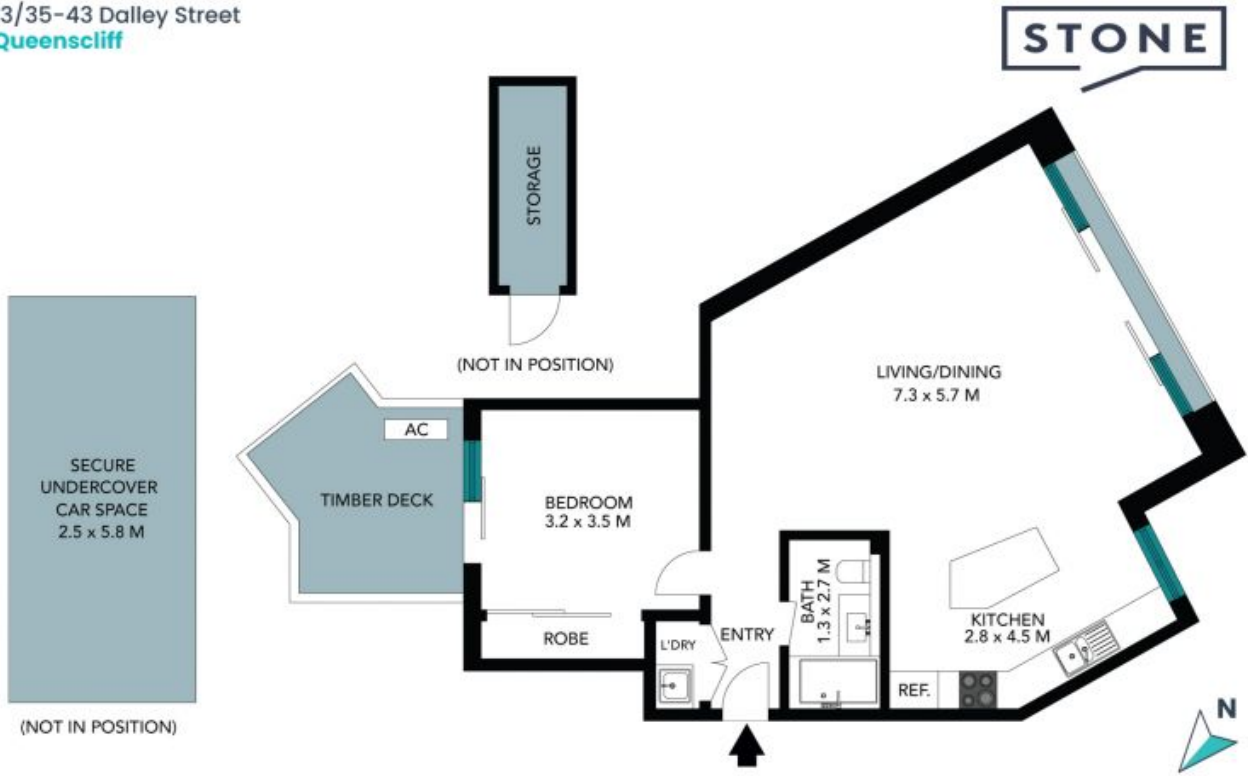

The floor plan is not to scale, measurements are indicative and in metres. Exterior elements are not in position. Plans should not be relied on. Interested parties should make and rely on their own enquiries. All other information provided has been collected from reliable sources but cannot be guaranteed for accuracy.

13/35-43 Dalley Street
Queenscliff

STONE



The floor plan is not to scale, measurements are indicative and in metres. All features included in this 3D plan are for inspiration purposes only. This is not an exact replica of the property or the position of exterior elements. Plans should not be relied on. Interested parties should make and rely on their own enquiries.