

23 Linga Longa Road Yarramalong, NSW

2 

1 

1 

SOLD BY SCOTT WALL!

Escape to the Yarramalong lifestyle with this beautifully crafted cottage, offering the perfect blend of charm and convenience. Ideal for retired couples or young first-time homebuyers, this unique retreat boasts an exceptional chef's kitchen, high ceilings, and sun-drenched living spaces that flow seamlessly to generous decks-all with a stunning park reserve backdrop.

Price: \$830,000



Scott Wall

0413 965 616



Kaela Wall

0434 726 944

23 Linga Longa Road
YARRAMALONG

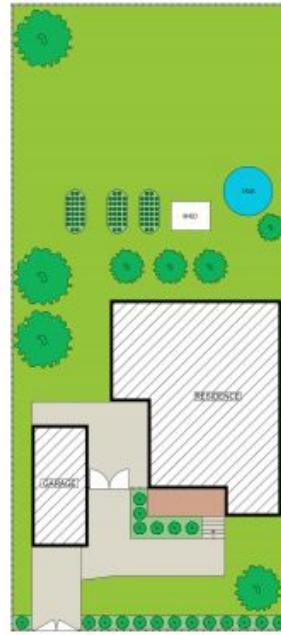

INTERNAL: 101sqm
EXTERNAL: 84sqm

PLEASE NOTE: These Floorplan + Site Plans have been generated for marketing purposes and are to be used as a guide only. While all care is taken, no guarantee can be given in respect of accuracy, sizes and dimensions are approximate, actual may vary.

