



7 Neath Street Pelaw Main, NSW

3

1

4

### 1930s Period Cottage Awaits a Glorious Revival

Nestled on the cusp of Kurri Kurri surrounded by parks and bushland awaits this charming near century old Pelaw Main period cottage set on a level quarter acre property. For those that value rich character and history this home presents a fabulous opportunity to revive and preserve this well-kept elegant piece of our past.

Price: \$595,000



**Renee Bean-Wyper**

0403 325 076



**Jorja Pauling**

0435 930 665

7 Neath Street  
Pelaw Main

STONE

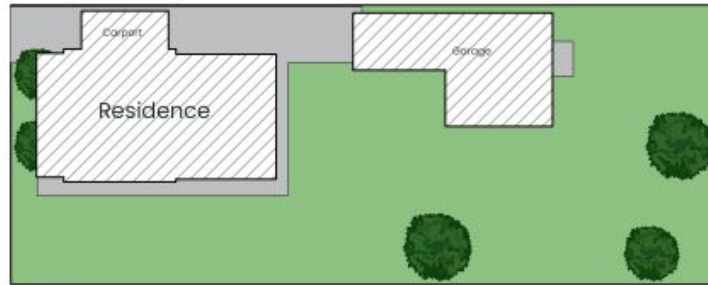
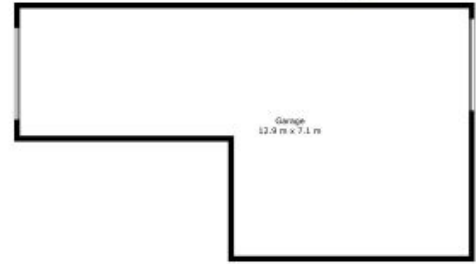

Site Map



The site plan and floor plan are not to scale; measurements are indicative and in metres. Bushes and trees are placed for illustration purposes. Plans should not be relied on, interested parties should make and rely on their own enquiries. All other information provided has been collected from reliable sources but cannot be guaranteed for accuracy.