

5/1 Links Avenue Roseville, NSW 3  2  1 

Spacious Townhouse in Convenient Location

Enjoy a lifestyle of effortless convenience in this oversized full brick townhouse offering a spacious open plan layout that seamlessly transitions to a large and private courtyard garden, perfect for entertaining. Set in a boutique complex of only 7, and within close proximity to Roseville Chase shops, Roseville Golf Club and convenient to schools, foreshore reserves and walking tracks and Chatswood shopping, dining and cinemas.

Price: Leased
Available Date: 07/09/2024



Ruby Gibson
0420 466 538



Alicia Sudol
0459 996 944

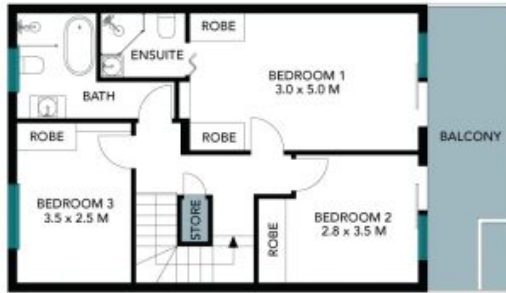

Upper Floor



Basement



Ground Floor



The floor plan is not to scale, measurements are indicative and in metres. Colour elements are not in position. Plans should not be relied on. Interested parties should make and rely on their own enquiries. All other information provided has been collected from reliable sources but cannot be guaranteed for accuracy.

5/1 Links Avenue
Roseville



Upper Floor



Basement



Ground Floor



The floor plan is not to scale; measurements are indicative and in metres. All features included in this 3D plan are for inspiration purposes only. This is not an exact replica of the property or the position of exterior elements. Plans should not be relied on. Interested parties should make and rely on their own enquiries.