



344/17-19 Memorial Avenue St Ives, NSW



Impressive resort appeal in blue-chip location

Offering a superlative standard of living in Lorelea Gardens, this exemplary apartment flows across two spacious levels with both opening to generous alfresco areas. The vast living connects to a large well-protected covered balcony streaming with north sunshine, while the restful ground floor main bedroom has a private paved courtyard. Enjoy resort style on-site facilities, with a heated indoor pool, gym, and beautifully landscaped gardens. The blue-chip location is a short level stroll to the local lifestyle hub of St Ives Village shops, Stanley Street cafes, and transport, and falls within St Ives North Primary School zone.

- 138sqm on title, security complex, townhouse style layout, north aspect
- Light-filled living and dining flowing to the large well protected balcony
- Chic stone kitchen, gas cooktop, oven, dishwasher, abundant storage
- Two large bedrooms, b.i. robes, main with ensuite and secluded courtyard
- Bedroom layout ideal for share-house living with a bathroom for each level
- Versatile layout for couples with option to use the main bed as 2nd living
- Fully tiled bathrooms, ensuite with bath, stone topped vanity cupboards
- Keep dry and entertain in style on the balcony enjoying the garden view

Price: Contact Agent
Council Rates: \$350.00 p/q
Water Rates: \$160.00 p/q
Strata Rates: \$1,798.00 p/q



Susan Astridge

0418 104 540

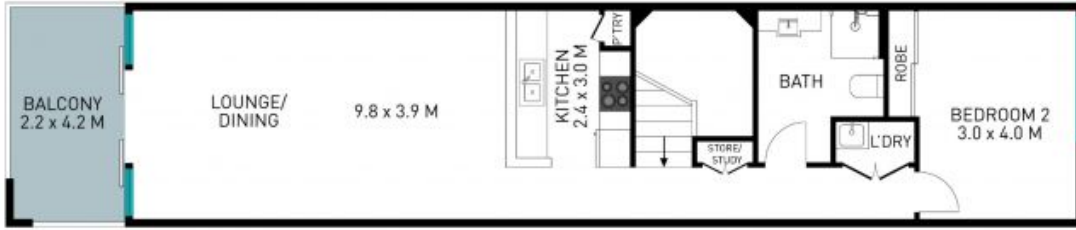

FIRST FLOOR



GROUND FLOOR



Total Area: 138 sqm

The site plan and floor plan are not to scale; measurements are indicative and in metres. Bushes and trees are placed for illustration purposes. Plans should not be relied on. Interested parties should make and rely on their own enquiries. All other information provided has been collected from reliable sources but cannot be guaranteed for accuracy.