



510/55 Harbour Street Mosman, NSW



Executive Living - UNDER CONTRACT

Capturing the essence of contemporary luxury and open space with a clever dual-level design, this inviting apartment offers a cosmopolitan lifestyle.

Price:

Contact Marize Bellomo



Marize Bellomo

0414 972 203



Alanna Tohme

0450 862 088

510/55 Harbour Street
Mosman



Level One

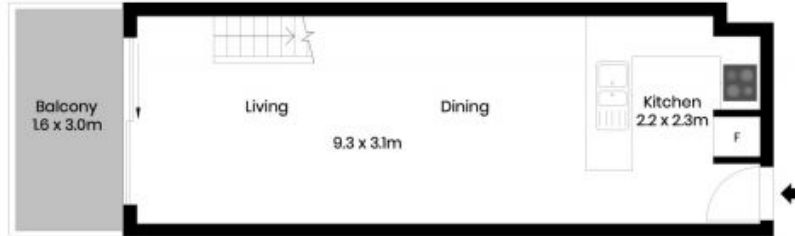

Entry Level

Secure Car Space
(Not in Position)

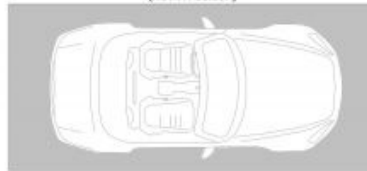

The site plan and floor plan are not to scale; measurements are indicative and in metres. Bushes and trees are placed for illustration purposes. Plans should not be relied on. Interested parties should make and rely on their own enquiries. All other information provided has been collected from reliable sources but cannot be guaranteed for accuracy.