



8/195 Bexley Road Kingsgrove, NSW

2 1 1

Two Bedroom Top Floor Unit

Enjoying a northerly aspect this bright unit is located on the top floor of a small security block. Offering:

Price: Deposit Taken - \$550 pw
Available Date: 30/09/2024



Evan Skagias

0405 588 885

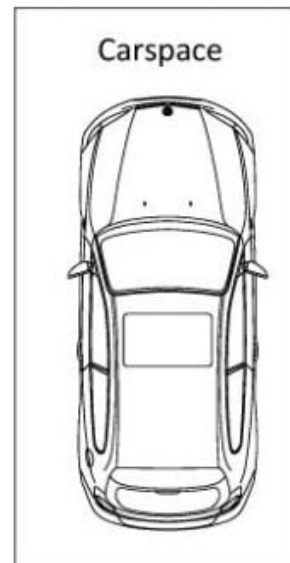
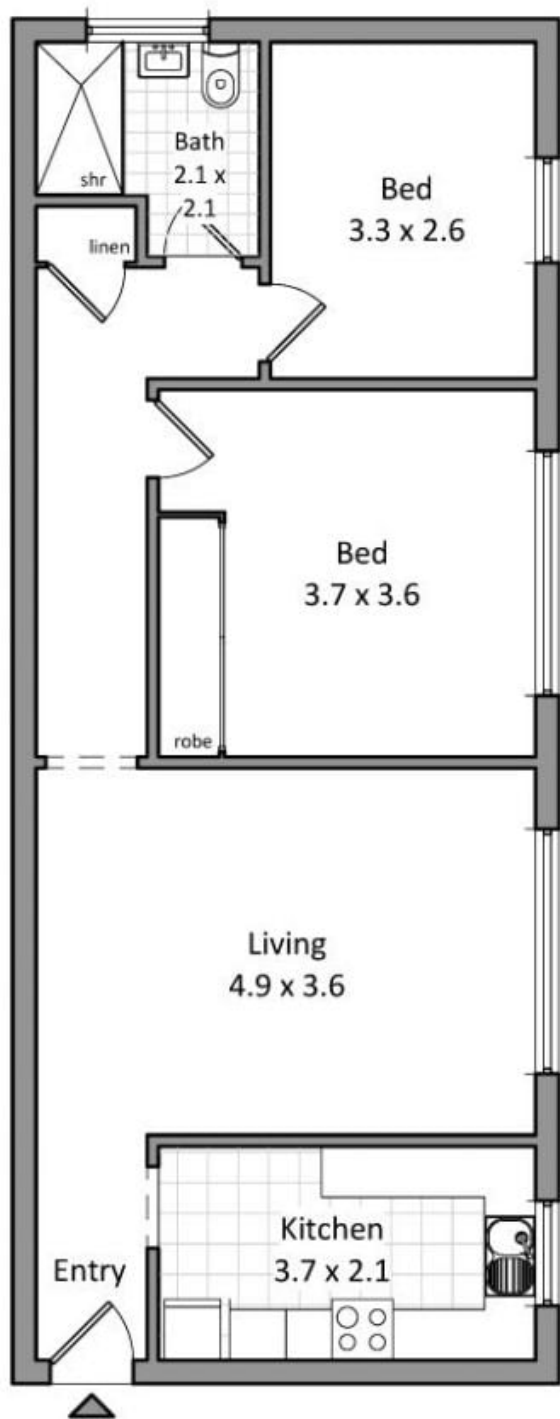

Floor plan



This diagram is for illustrative purpose only. All reasonable care has been taken in the preparation, but no warranty is given as to the accuracy of the information. This document does not constitute any part of any offer or contract. Dimensions shown are approximate only. Prospective purchasers must rely on their own enquiries. Floor plan by SanDesign 0410581805.

8/195 Bexley Road, Kingsgrove