



26 Paperbark Street Crestmead, QLD



### HIGH SET HOME WITH SO MUCH POTENTIAL - SET ON 795M2

This much loved family home is first time onto the market in over 20 years and is set on a generous 795m2 allotment and offers so much potential to a future buyer, whether you are an investor, homeowner, or have been watching the block and have design ideas, you will love this home!

Price:

CONTACT AGENT



**Claire Franklin**

0430 438 889



**Leanne & Bridgette**

0413 817 092

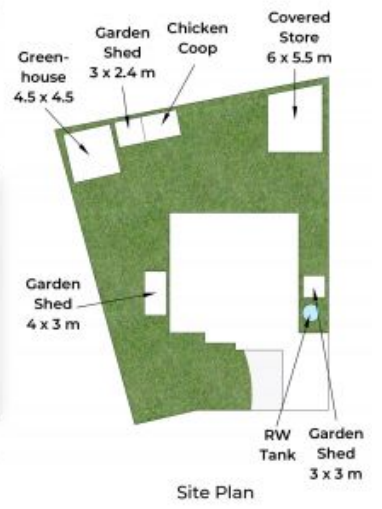
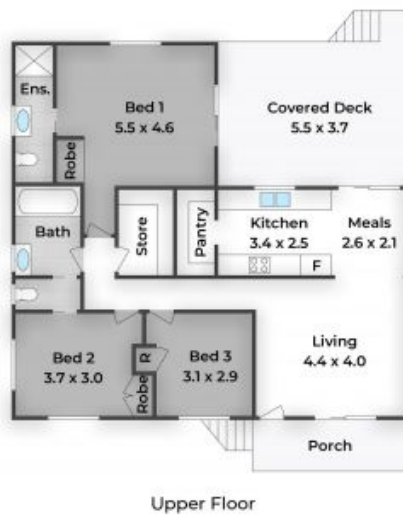
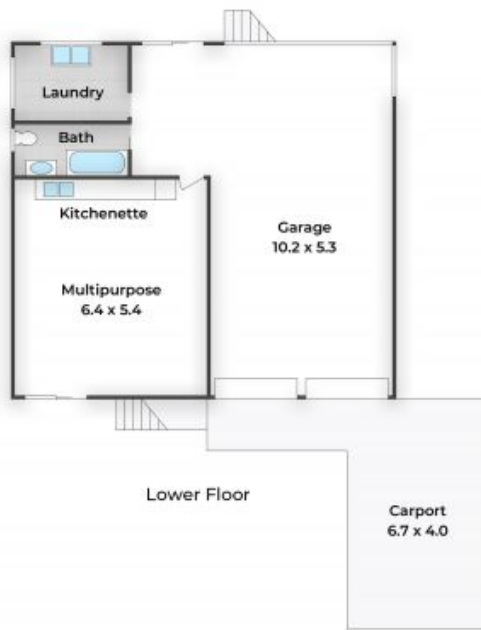

Approx. Floor Area | Internal 222 m<sup>2</sup> | External 64 m<sup>2</sup> | Total 286 m<sup>2</sup> | Lot 795 m<sup>2</sup>

Unless otherwise stated, all dimensions are in metres. Star arrows indicate the upward direction. This plan and information contained within is for illustrative purposes only and not guaranteed to be exact. Interested parties should make their own enquiries.

