



30A Archbold Road Roseville, NSW



Quality east side entry point, walk to rail

All the hard work is done in this stylishly updated and light-filled double brick home, offering an exceptionally comfortable entry-point to Roseville's coveted east side. Set well back from the street in private fully fenced gardens, with a single level layout, new kitchen and renovated bathroom. Included in prime school zones, with 1km walk to rail.

Price:

Contact Agent



Jill Henry

0416 493 555



Sahil Kotian

0434 172 588



The floor plan is not to scale, measurements are indicative and in metres. Solar or elements are not to position. Plans should not be relied on. Interested parties should make and rely on their own enquiries. All other information provided has been collected from reliable sources but cannot be guaranteed for accuracy.

30A Archbold Road, Roseville



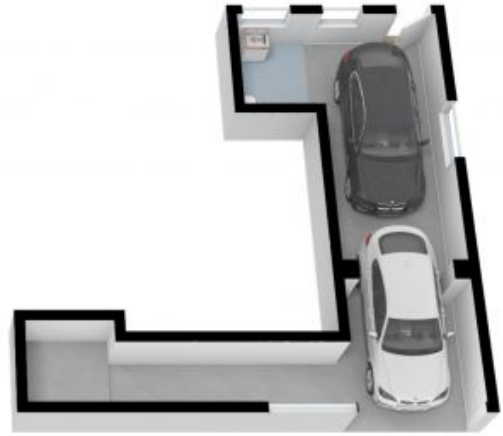

The floor plan is not to scale, measurements are indicative and in metres. All features included in this 3D plan are for inspiration purposes only. This is not an exact replica of the property or the position of exterior elements. Plans should not be relied on. Interested parties should make and rely on their own enquiries.

30A Archbold Road, Roseville

