



62 Eton Road Lindfield, NSW



Enjoy, Renovate or Rebuild

Set on sundrenched 834sqm block, on the high side of the street, this family favourite features light-filled, updated interiors, a large garden and is ideally situated for transport, shops and popular schools. Comfortably living as is, with scope to renovate or build a magnificent new home (STCA) with plenty of room for a pool.

Price:

Contact Agent



Jill Henry

0416 493 555



Sahil Kotian

0434 172 588

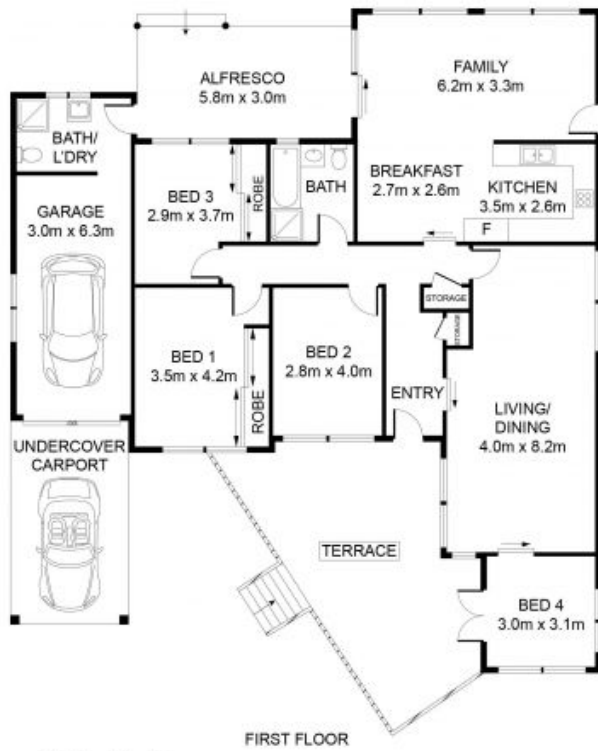

62 Eton Road, Lindfield

DISCLAIMER: 3D Property View accepts no liability for the accuracy of details contained within our floor plans. All plans are drawn and also checked to the best of our ability, however information contained in our floor plans such as area calculations are approximate, and have not been surveyed or drawn to scale. Our floor plans are for representational purposes only and should be used as such. Do not attempt to refer to our floor plans for structural or detailed information.