



39 Shirley Road Roseville, NSW



Character opportunity prized walk to rail locale

Capitalise on the extraordinary potential of "Osterley" c.1920, a charming full brick character home, set on a 923sqm (approx.) parcel of level land, and offering a convenient walk to rail position in one of the area's premier streets. Ripe for renovation (subject to council approval) and showcasing beautifully intact original features.

Price: \$3,811,000



Jill Henry

0416 493 555



Sahil Kotian

0434 172 588

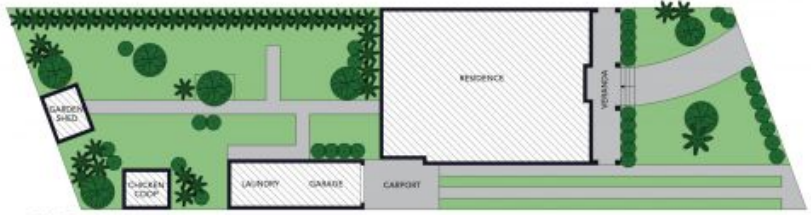

SITE PLAN



The site plan and floor plan are not to scale, measurements are indicative and in metres. Shades and lines are placed for illustration purposes. Plans should not be relied on. Interested parties should make and rely on their own enquiries. All other information provided has been collected from reliable sources but cannot be guaranteed for accuracy.

39 Shirley Road, Roseville





The floor plan is not to scale, measurements are indicative and in metres. All features included in this 3D plan are for inspiration purposes only. This is not an exact replica of the property or the position of exterior elements. Plans should not be relied on. Interested parties should make and rely on their own enquiries.

39 Shirley Road, Roseville

