



34 Slade Street Naremburn, NSW

3

1

Picturesque charm in lifestyle location

What a charmer! This tastefully renovated circa 1910 semi features a harmonious fusion of decorative character and contemporary comfort for relaxed in/outdoor living and entertaining. Surprisingly quiet yet ultra convenient, this private haven in Naremburn's premier precinct is footsteps to village shops, cafes, express bus & schools, mins to Chatswood and one traffic light to the City.



Jimmy Psaltis

0411 129 221

34 Slade Street
Naremburn

STONE

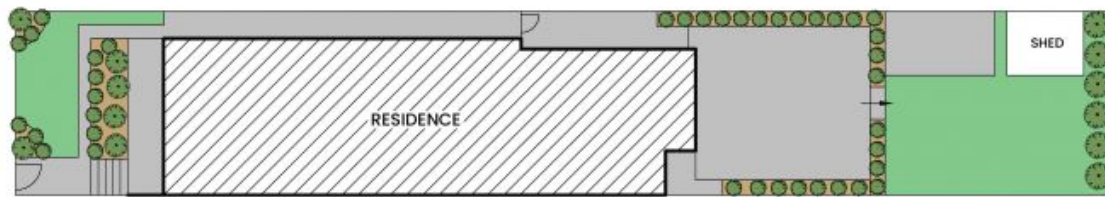

Site Plan

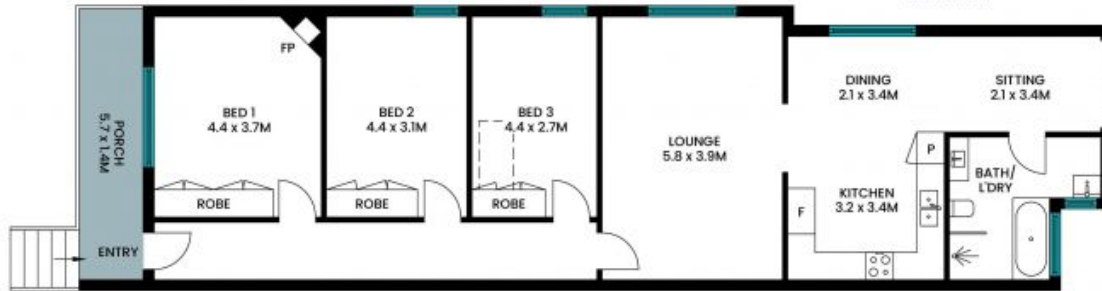

Ground Floor

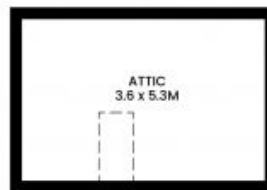

Attic



Internal area: 133m²
Covered external area: 8m²
Total area: 141m²

The site plan and floor plan are not to scale; measurements are indicative and in metres. Bushes and trees are placed for illustration purposes. Plans should not be relied on. Interested parties should make and rely on their own enquiries. All other information provided has been collected from reliable sources but cannot be guaranteed for accuracy.