



3 Thomas Avenue Roseville, NSW



Updated Federation stunner with walk to rail

Impeccably presented, this character-rich family home showcases elegant period appeal flawlessly melded with tasteful modern updates. Stylish light-filled interiors gracefully flow through bifold doors to the private outdoor entertaining terrace wrapped in Peter Fudge gardens. Set on the high side of a premier cul-de-sac, with the advantage of rear lane access and popular Loyal Henry Park at the end of the street, with a short walk to shops and rail.

Price: Contact Agent
Council Rates: \$600.00 p/q
Water Rates: \$160.00 p/q



Jill Henry
0416 493 555



Sahil Kotian
0434 172 588

3 Thomas Avenue,
Roseville



Ground Floor

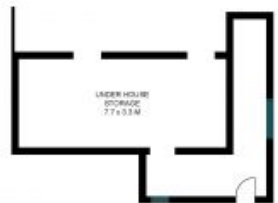

Basement

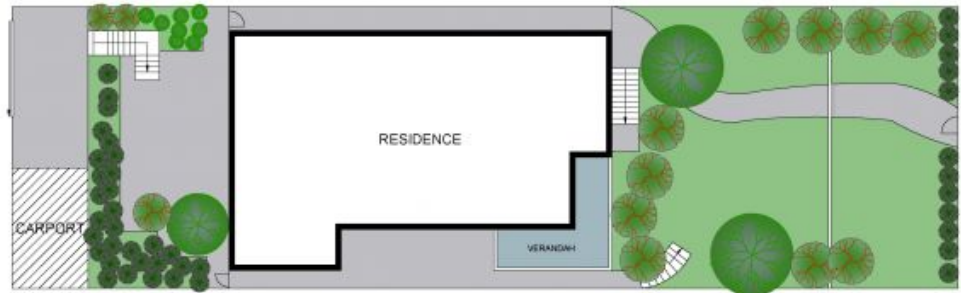

Site Plan



The site plan and floor plan are not to scale; measurements are indicative and in metres. Bushes and trees are placed for illustration purposes. Plans should not be relied on. Interested parties should make and rely on their own enquiries. All other information provided has been collected from reliable sources but cannot be guaranteed for accuracy.