

5/329-331 Victoria Avenue Chatswood, NSW



Lifestyle Location

A superior starter or solid investment in this ultra central location with shops, cafes, eateries & City bus at the door and footsteps to shopping centres, business, dining and rail. This 2 double-bedroom first floor apartment in a boutique brick security building is bright and airy with ideal Easterly aspect, fresh paint, new carpet, high ceilings and generous living/dining flowing to a sundrenched balcony. Ready to rent out or move in and enjoy ultimate lifestyle convenience in this key position, with room to further update and add value.



Jimmy Psaltis

0411 129 221



Alex Andonian

0432 018 535

5/329-331 Victoria Avenue
Chatswood

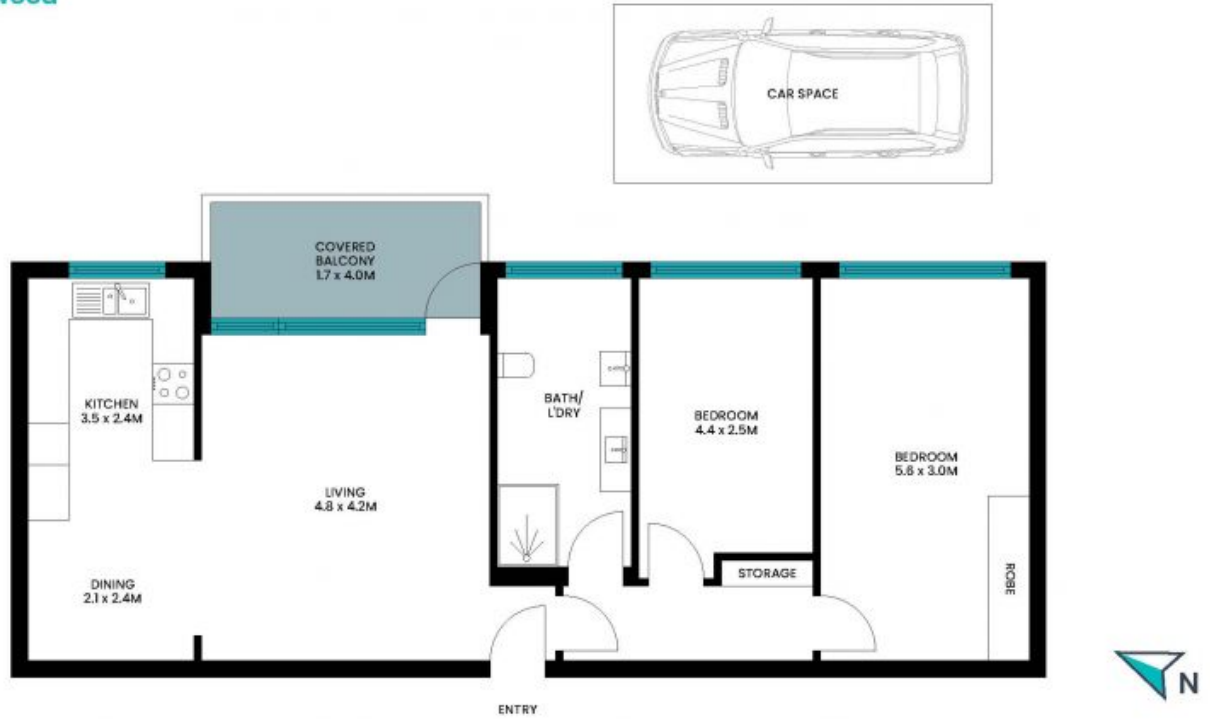

Total area: 94m² approx.

The site plan and floor plan are not to scale; measurements are indicative and in metres. Bushes and trees are placed for illustration purposes. Plans should not be relied on. Interested parties should make and rely on their own enquiries. All other information provided has been collected from reliable sources but cannot be guaranteed for accuracy.