



18/11 Hampden Road Artarmon, NSW 2 1 1

Tranquil Treetop Retreat

A peaceful sundrenched sanctuary at the heart of Artarmon village lifestyle. This freshly-painted North facing apartment on the top floor of a traditional boutique complex offers a spacious light-filled living room. Set behind expansive lawned gardens, the low rise block of 24 units offers country quiet in this parkland position just minutes walk to local shops, cafes, rail and school, convenient to Royal North Shore Hospital, moments to the City expressway & minutes to Chatswood shopping and CBD.

Council Rates: \$380.70 p/q
Water Rates: \$172.92 p/q



Alex Andonian
0432 018 535



Jimmy Psaltis
0411 129 221

18/11 Hampden Road
Artarmon

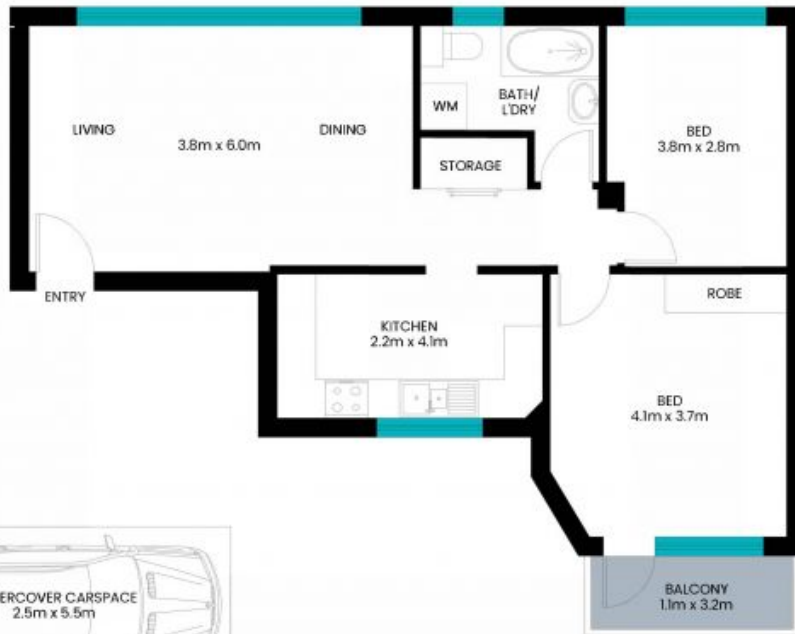

(NOT ACTUAL LOCATION)



Internal area: 79m²
Car Space: 13m²
Total: 92m² (APPROX.)

The site plan and floor plan are not to scale; measurements are indicative and in meters. Bushes and trees are placed for illustration purposes. Plans should not be relied on. Interested parties should make and rely on their own enquire. All other information provided has been collected from reliable sources but cannot be guaranteed for accuracy.