



3/35 East Esplanade Manly, NSW

2 1 2

### Harbourfront apartment with postcard-perfect views

Positioned directly opposite Manly Cove Beach with dreamy views reaching down the harbour to The Eastern Suburbs, this bright and spacious security apartment is pure harbourfront bliss. Move straight in and live it up just footsteps from beaches, Manly Wharf and a smorgasbord of world-class bars, brasseries and restaurants.

Price: Leased  
Available Date: 07/11/2024



**Anthony Zakos**

0419 503 000



**Alicia Sudol**

0459 996 944

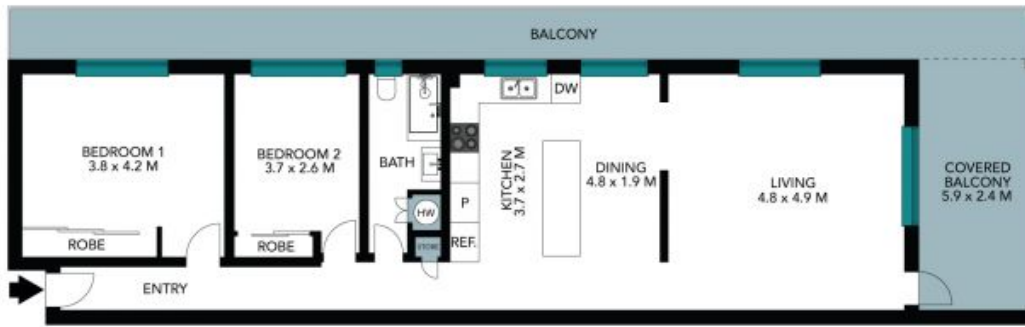

The floor plan is not to scale, measurements are indicative and in metres. Colour elements are not in position. Plans should not be relied on. Interested parties should make and rely on their own enquiries. All other information provided has been collected from reliable sources but cannot be guaranteed for accuracy.

3/35 East Esplanade  
Manly

STONE



The floor plan is not to scale; measurements are indicative and in metres. All features included in this 3D plan are for inspiration purposes only. This is not an exact replica of the property or the position of exterior elements. Plans should not be relied on. Interested parties should make and rely on their own enquiries.