



43 Melbourne Road Wadalba, NSW



Immaculate, Renovated Family Home

Presenting the perfect opportunity to acquire this sensational renovated property, where all the hard work has been done for you. Simply move in and enjoy! Designed to embrace family lifestyle, this impressively proportioned four -bedroom home is well located in this sought after suburb.

Price: \$892,000



Louise Barwick

0450 560 478

43 Melbourne Rd, Wadalba NSW 2259

STONE



FLOOR PLAN

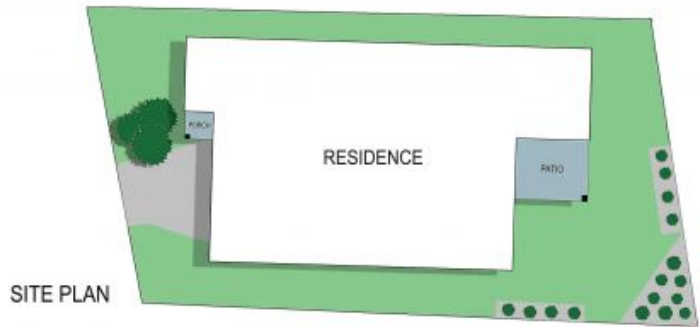

SITE PLAN

The Floor plan is not to scale; measurements are indicative and in metres. Plans should not be relied on. Interested parties should make and rely on their own enquiries. All other information provided has been collected from reliable sources but cannot be guaranteed for accuracy.