



24 Yarraman Drive Kingston, TAS



Family Sized Complete With Spa Ensuite

The central location of this family friendly home will be just one of the attractions for those wanting ease of access to transport, schools and the central shopping hub of Kingston. Then add to that the spa ensuite, the ideal place for Mum & Dad to spoil themselves, multiple living spaces for all to enjoy and a covered entertaining area to catch up with family and friends while the kids play in the safe and secure back yard and it keeps getting better.

The home chef will adore the spacious galley style kitchen packed with drawer and cupboard space, gas equipped cooking and dish drawer dish washer.

As mentioned you have a great level yard and also excellent parking options having a double garage, complete with internal access and then other parking spaces out front and possibilities of access into the rear yard if required.

All in all a great family package or one for those craving a little bit of extra space.

Price: \$440,000 - \$460,000

Stone Real Estate

Southern Tasmania

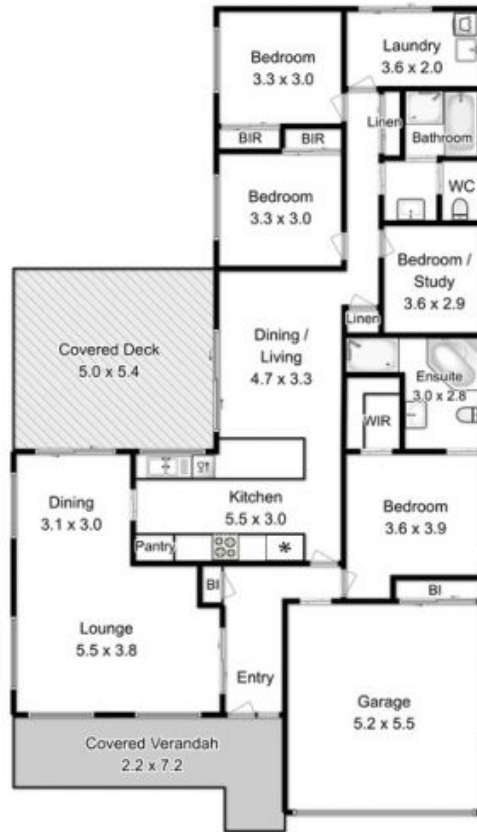

All measurements are internal and approximate.
 This plan is a sketch for illustration, not valuation.
 Produced by Open2view.com

Approx. house area: 193 sqm

